

Woodruff Keys

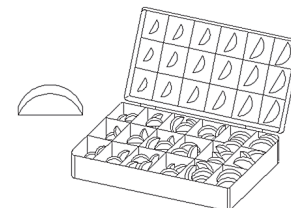

A-WK01	1/16 x 3/8 Woodruff Keys PKG QTY: 20
A-WK02	1/16 x 1/2 Woodruff Keys PKG QTY: 20
A-WK03	3/32 X 3/8 Woodruff Keys PKG QTY: 20
A-WK04	3/32 X 1/2 Woodruff Keys PKG QTY: 20
A-WK05	3/32 x 5/8 Woodruff Keys PKG QTY: 20
A-WK06	1/8 x 3/8 Woodruff Keys PKG QTY: 20
A-WK07	1/8 x 1/2 Woodruff Keys PKG QTY: 20
A-WK08	1/8 x 5/8 Woodruff Keys PKG QTY: 20
A-WK09	1/8 x 3/4 Woodruff Keys PKG QTY: 20
A-WK10	5/32 x 5/8 Woodruff Keys PKG QTY: 20
A-WK11	5/32 x 3/4 Woodruff Keys PKG QTY: 20
A-WK12	5/32 x 7/8 Woodruff Keys PKG QTY: 20
A-WK13	3/16 x 5/8 Woodruff Keys PKG QTY: 20
A-WK14	3/16 x 3/4 Woodruff Keys PKG QTY: 20
A-WK15	3/16 x 7/8 Woodruff Keys PKG QTY: 20
A-WK16	3/16 x 1 Woodruff Keys PKG QTY: 10
A-WK17	3/16 x 1-1/8 Woodruff Keys PKG QTY: 10
A-WK18	3/16 x 1-1/4 Woodruff Keys PKG QTY: 10
A-WK19	3/16 x 2-1/8 Woodruff Keys PKG QTY: 10
A-WK20	7/32 x 7/8 Woodruff Keys PKG QTY: 10
A-WK21	7/32 x 1 Woodruff Keys PKG QTY: 10
A-WK22	7/32 x 1-1/4 Woodruff Keys PKG QTY: 10
A-WK23	1/4 x 3/4 Woodruff Keys PKG QTY: 10

A-WK24	1/4 x 7/8 Woodruff Keys PKG QTY: 10
A-WK25	1/4 x 1 Woodruff Keys PKG QTY: 10
A-WK26	1/4 x 1-1/8 Woodruff Keys PKG QTY: 10
A-WK27	1/4 x 1-1/4 Woodruff Keys PKG QTY: 5
A-WK28	1/4 x 1-1/2 Woodruff Keys PKG QTY: 5
A-WK29	1/4 x 2-1/8 Woodruff Keys PKG QTY: 5
A-WK30	5/16 x 1 Woodruff Keys PKG QTY: 5
A-WK31	5/16 x 1-1/8 Woodruff Keys PKG QTY: 5
A-WK32	5/16 x 1-1/4 Woodruff Keys PKG QTY: 5
A-WK33	5/16 x 1-3/8 Woodruff Keys PKG QTY: 5
A-WK34	5/16 x 1-1/2 Woodruff Keys PKG QTY: 5
A-WK35	5/16 x 2-1/8 Woodruff Keys PKG QTY: 5
A-WK36	3/8 x 2-1/8 Woodruff Keys PKG QTY: 5
A-WK37	3/8 x 1-1/4 Woodruff Keys PKG QTY: 5
A-WK38	3/8 x 1-3/8 Woodruff Keys PKG QTY: 5
A-WK39	3/8 x 1-1/2 Woodruff Keys PKG QTY: 5
A-WK40	3/8 x 2-3/4 Woodruff Keys PKG QTY: 5



A-WK250	250 Pc. Woodruff Key Assortment <i>Notes: Contains: (10) A-WK01, (10) A-WK02, (20) A-WK03, (15) A-WK04, (10) A-WK05, (10) A-WK06 (15) A-WK07, (30) A-WK08, (20) A-WK09, (50) A-WK10 (10) A-WK11, (5) A-WK12, (5) A-WK13, (20) A-WK14, (5) A-WK15, (5) A-WK20, (5) A-WK23, (5) A-WK24</i>
---------	--

Parts are not Original Equipment parts and are not sponsored, affiliated or otherwise connected with any major brand.

Machinery Bushings

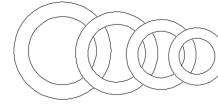
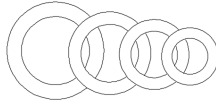

Parts are not Original Equipment parts and are not sponsored, affiliated or otherwise connected with any major brand.

A-MB01 1/2" I.D. 3/4" O.D. 14 Ga. Narrow Rim Machinery Bushings
 [i.d.]: 12
 [o.d.]: 3/4"
 [ga.]: 14
 PKG QTY: 25

A-MB02 1/2" I.D. 7/8" O.D. 18 Ga. Narrow Rim Machinery Bushings
 [i.d.]: 12
 [o.d.]: 7/8"
 [ga.]: 18
 PKG QTY: 25

A-MB03 9/16" I.D. 1" O.D. 18 Ga. Narrow Rim Machinery Bushings
 [i.d.]: 916
 [o.d.]: 1"
 [ga.]: 18
 PKG QTY: 25

A-MB04 5/8" I.D. 1-1/8" O.D. 18 Ga. Narrow Rim Machinery Bushings
 [i.d.]: 58
 [o.d.]: 1-1/8"
 [ga.]: 18
 PKG QTY: 25

A-MB05 3/4" I.D. 1-1/4" O.D. 18 Ga. Narrow Rim Machinery Bushings
 [i.d.]: 34
 [o.d.]: 1-1/4"
 [ga.]: 18
 PKG QTY: 25

A-MB06 3/4" I.D. 1-1/4" O.D. 14 Ga. Narrow Rim Machinery Bushings
 [i.d.]: 34
 [o.d.]: 1-1/4"
 [ga.]: 14
 PKG QTY: 25

A-MB07 7/8" I.D. 1-3/8" O.D. 18 Ga. Narrow Rim Machinery Bushings
 [i.d.]: 78
 [o.d.]: 1-3/8"
 [ga.]: 18
 PKG QTY: 25

A-MB08 7/8" I.D. 1-3/8" O.D. 14 Ga. Narrow Rim Machinery Bushings
 [i.d.]: 78
 [o.d.]: 1-3/8"
 [ga.]: 14
 PKG QTY: 25

A-MB09 1" I.D. 1-1/2" O.D. 18 Ga. Narrow Rim Machinery Bushings
 [i.d.]: 1
 [o.d.]: 1-1/2"
 [ga.]: 18
 PKG QTY: 25

A-MB10 1" I.D. 1-1/2" O.D. 14 Ga. Narrow Rim Machinery Bushings
 [i.d.]: 1
 [o.d.]: 1-1/2"
 [ga.]: 14
 PKG QTY: 25

A-MB11 1-1/8" I.D. 1-3/4" O.D. 18 Ga. Narrow Rim Machinery Bushings
 [i.d.]: 118
 [o.d.]: 1-3/4"
 [ga.]: 18
 PKG QTY: 25

A-MB12 1-1/8" I.D. 1-3/4" O.D. 14 Ga. Narrow Rim Machinery Bushings
 [i.d.]: 118
 [o.d.]: 1-3/4"
 [ga.]: 14
 PKG QTY: 25

A-MB13 1-1/4" I.D. 1-7/8" O.D. 18 Ga. Narrow Rim Machinery Bushings
 [i.d.]: 114
 [o.d.]: 1-7/8"
 [ga.]: 18
 PKG QTY: 25

A-MB14 1-1/4" I.D. 1-7/8" O.D. 14 Ga. Narrow Rim Machinery Bushings
 [i.d.]: 114
 [o.d.]: 1-7/8"
 [ga.]: 14
 PKG QTY: 25

A-MB15 1-3/8" I.D. 2-1/8" O.D. 18 Ga. Narrow Rim Machinery Bushings
 [i.d.]: 138
 [o.d.]: 2-1/8"
 [ga.]: 18
 PKG QTY: 25

A-MB16 1-3/8" I.D. 2-1/8" O.D. 14 Ga. Narrow Rim Machinery Bushings
 [i.d.]: 138
 [o.d.]: 2-1/8"
 [ga.]: 14
 PKG QTY: 25

A-MB17 1-1/2" I.D. 2-1/4" O.D. 14 Ga. Narrow Rim Machinery Bushings
 [i.d.]: 112
 [o.d.]: 2-1/4"
 [ga.]: 14
 PKG QTY: 25

A-MB18 1-5/8" I.D. 2-3/8" O.D. 14 Ga. Narrow Rim Machinery Bushings
 [i.d.]: 158
 [o.d.]: 2-3/8"
 [ga.]: 14
 PKG QTY: 25

SHOP SUPPLY

Machinery Bushings

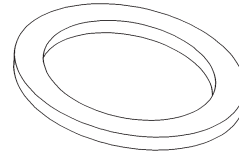
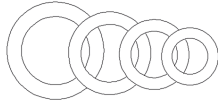

A-MB19	1-3/4" I.D. 2-1/2" O.D. 14 Ga. Narrow Rim Machinery Bushings [i.d.]: 134 [o.d.]: 2-1/2" [ga.]: 14 PKG QTY: 25
A-MB20	1-3/4" I.D. 2-1/2" O.D. 10 Ga. Narrow Rim Machinery Bushings [i.d.]: 134 [o.d.]: 2-1/2" [ga.]: 10 PKG QTY: 25
A-MB21	1-7/8" I.D. 2-7/8" O.D. 14 Ga. Narrow Rim Machinery Bushings [i.d.]: 178 [o.d.]: 2-7/8" [ga.]: 14 PKG QTY: 25
A-MB22	2" I.D. 3" O.D. 14 Ga. Narrow Rim Machinery Bushings [i.d.]: 2 [o.d.]: 3" [ga.]: 14 PKG QTY: 25
A-MB23	2-1/8" I.D. 3-1/8" O.D. 14 Ga. Narrow Rim Machinery Bushings [i.d.]: 218 [o.d.]: 3-1/8" [ga.]: 14 PKG QTY: 25
A-MB24	2-1/4" I.D. 3-1/4" O.D. 14 Ga. Narrow Rim Machinery Bushings [i.d.]: 214 [o.d.]: 3-1/4" [ga.]: 14 PKG QTY: 25
A-MB25	2-3/8" I.D. 3-3/8" O.D. 14 Ga. Narrow Rim Machinery Bushings [i.d.]: 238 [o.d.]: 3-3/8" [ga.]: 14 PKG QTY: 25
A-MB26	2-1/2" I.D. 3-1/2" O.D. 14 Ga. Narrow Rim Machinery Bushings [i.d.]: 212 [o.d.]: 3-1/2" [ga.]: 14 PKG QTY: 25
A-MB27	3" I.D. 4-1/4" O.D. 14 Ga. Narrow Rim Machinery Bushings [i.d.]: 3 [o.d.]: 4-1/4" [ga.]: 14 PKG QTY: 25

A-MB28	3/4" I.D. 1 1/2" O.D. 18 Ga. Wide Rim Bushings [I.D.]: 34 [O.D.]: 1-1/2" [ga.]: 18 PKG QTY: 25
A-MB29	7/8" I.D. 1-3/4" O.D. 18 Ga. Wide Rim Bushings [I.D.]: 78 [O.D.]: 1-3/4" [ga.]: 18 PKG QTY: 25
A-MB30	1" I.D. 2" O.D. 18 Ga. Wide Rim Bushings [I.D.]: 1 [O.D.]: 2" [ga.]: 18 PKG QTY: 25
A-MB31	1-1/8" I.D. 2-1/8" O.D. 18 Ga. Wide Rim Bushings [I.D.]: 118 [O.D.]: 2-1/8" [ga.]: 18 PKG QTY: 25
A-MB32	1-1/4" I.D. 2-1/4" O.D. 18 Ga. Wide Rim Bushings [I.D.]: 114 [O.D.]: 2-1/4" [ga.]: 18 PKG QTY: 25
A-MB33	1-3/8" I.D. 2-1/2" O.D. 18 Ga. Wide Rim Bushings [I.D.]: 138 [O.D.]: 2-1/2" [ga.]: 18 PKG QTY: 25
A-MB34	1-1/2" I.D. 3" O.D. 18 Ga. Wide Rim Bushings [I.D.]: 112 [O.D.]: 3" [ga.]: 18 PKG QTY: 25
A-MB35	1-3/4" I.D. 3-1/4" O.D. 18 Ga. Wide Rim Bushings [I.D.]: 134 [O.D.]: 3-1/4" [ga.]: 18 PKG QTY: 25
A-MB36	2" I.D. 3-1/2" O.D. 18 Ga. Wide Rim Bushings [I.D.]: 2 [O.D.]: 3-1/2" [ga.]: 18 PKG QTY: 25
A-MB37	2-1/8" I.D. 3-5/8" O.D. 18 Ga. Wide Rim Bushings [I.D.]: 218 [O.D.]: 3-5/8" [ga.]: 18 PKG QTY: 25
A-MB38	2-1/4 I.D. 3-3/4" O.D. 18 Ga. Wide Rim Bushings [I.D.]: 214 [O.D.]: 3-3/4" [ga.]: 18 PKG QTY: 25

Parts are not Original Equipment parts and are not sponsored, affiliated or otherwise connected with any major brand.

Split Washers



A-MBDB01 Machinery Bushing Display

Notes: Display board Comes Complete w/ 22 angle screw hooks packed w/ 197 of the most popular size narrow rim and wide rim bushings, 9/16" thru 2-1/2".

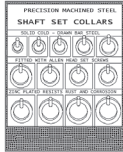

A-SCDB01 Set Collar Displays

INCLUDES: 45 Collars from 1/2" - 1 1/2"

Notes: Colorful, sturdy 1/4" masonite, 13" x 18" display board. Comes with hooks for 13 set collar sizes. Can be mounted on the wall or used as a detachable stand for counter displays.

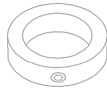

A-SC38 3/8" Set Collar
PKG QTY: 10

A-SC12 1/2" Set Collar
PKG QTY: 10

A-SC58 5/8" Set Collar
PKG QTY: 5

A-SC916 9/16" Set Collar
PKG QTY: 5

A-SC34 3/4" Set Collar
PKG QTY: 10

A-SC78 7/8" Set Collar
PKG QTY: 5

A-SC1516 15/16" Set Collar
PKG QTY: 5

A-SC1 1" Set Collar
PKG QTY: 5

A-SC118 1-1/8" Set Collar
PKG QTY: 5

A-SC1316 1-3/16" Set Collar
PKG QTY: 5

A-SC114 1-1/4" Set Collar
PKG QTY: 5

A-SC138 1-3/8" Set Collar
PKG QTY: 5

A-SC1716 1-7/16" Set Collar
PKG QTY: 5

A-SC112 1-1/2" Set Collar
PKG QTY: 5



A-SW01 3/4" x 1/8" Split Washer
PKG QTY: 10

A-SW02 7/8" x 1/8" Split Washer
PKG QTY: 10

A-SW03 1" x 1/8" Split Washer
PKG QTY: 10

A-SW04 1-1/8" x 1/8" Split Washer
PKG QTY: 10

A-SW05 1-1/4" x 1/8" Split Washer
PKG QTY: 10

A-SW07 1-1/2" x 1/8" Split Washer
PKG QTY: 10

A-SW08 1-3/4" x 1/8" Split Washer
PKG QTY: 10

A-SW09 2" x 1/8" Split Washer
PKG QTY: 10

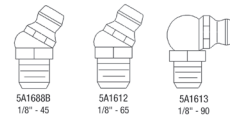

A-GF1845PT 1/8" - 45° Pipe Thread Fitting, 20 Pack

A-GF1865PT 1/8" - 65° Pipe Thread Fitting, 20 Pack

A-GF1890PT 1/8" - 90° Pipe Thread Fitting, 20 Pack

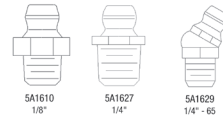

A-GF18PT 1/8" - Pipe Thread Fitting, 20 Pack

A-GF14PT 1/4" - Pipe Thread Fitting, 10 Pack

A-GF1465PT 1/4" - 65° Pipe Thread Fitting, 5 Pack

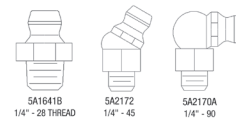

A-GF1428TT 1/4" - 28° Taper Thread Fitting, 20 Pack

A-GF1445TT 1/4" - 45° Taper Thread Fitting, 20 Pack

A-GF1490TT 1/4" - 90° Taper Thread Fitting, 20 Pack

Parts are not Original Equipment parts and are not sponsored, affiliated or otherwise connected with any major brand.

SHOP SUPPLY

Grease Fittings



- A-GF516D 5/16" Drive Type Fitting, 20 Pack

- A-GF14D 1/4" Drive Type Fittings, 20 Pack

- A-GF316D 3/16" Drive Type Fitting, 20 Pack

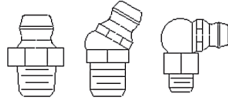

- A-GF6M 6mm ST. Metric Grease Fitting, 20 Pack

- A-GF645M 6mm 45° Metric Grease Fitting, 20 Pack

- A-GF690M 6mm 90° Metric Grease Fitting, 20 Pack

- A-GF8M 8mm ST. Metric Grease Fitting, 20 Pack

- A-GF845M 8mm 45° Metric Grease Fitting, 10 Pack

- A-GF890M 8mm 90° Metric Grease Fitting, 10 Pack

- A-GF10M 10mm ST. Metric Grease Fitting, 20 Pack

- A-GF1045M 10mm 45° Metric Grease Fitting, 10 Pack

- A-GF1090M 10mm 90° Metric Grease Fitting, 10 Pack

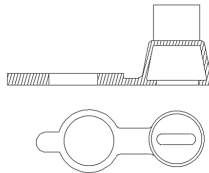

- A-GFC1 Grease Fitting Cap, 25 Pack
Notes: Made of polyethylene. The 5A 8 grease cap snaps securely over fittings to seal out dirt & moisture. Integral retaining ring keeps cap in place during servicing.

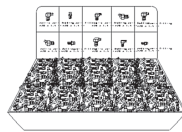

- A-GFA1 Standard Grease Fitting Assortment
Notes: Each Box Contains: (30) GF18PT, (30) GF1428TT, (10) GF1845PT, (10) GF1445TT, (10) GF1890PT, (10) GF1490TT

- A-GFCD1 Grease Fitting Counter Assortment
Notes: Contains: Pipethread 6-5A1888B, (6) A-GF1845PT, (6) A-GF1865PT, (6) A-GF1890PT, (8) A-GF18PT, (4) A-GF14PT, (4) A-GF1465PT, (10) A-GF1428TT, (8) A-GF1445TT, (8) A-GF1490TT, (15) A-GFC1.

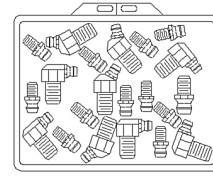

- A-MGFA1 Metric Grease Fitting Assortment
 DIM A (1): Case of 12
Notes: Metric grease fitting assortment contains 12 individual pkgs: (3) A-GF6M, (2) A-GF8M, (1) A-GF10M, (3) A-GF690M, (2) A-GF890M, (1) A-GF1090M.

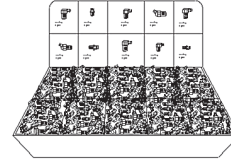

- A-MGFCD1 Metric Grease Fitting Counter Display
Notes: Contains: (10) A-GF6M, (10) A-GF690M, (10) A-GF845M, (6) A-GF10M, (6) A-GF1090M, (15) A-GFC1, (10) A-GFC45M, (10) A-GF8M, (10) A-GF890M, (6) A-GF1045M.

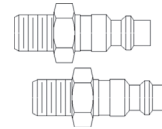

- A-VLA3508 Fitting, 1/4" Male
 PKG QTY: 2

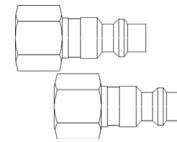

- A-VLA3509 Plug Female 1/4
 PKG QTY: 2

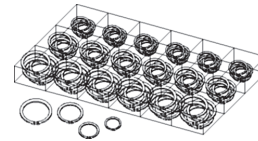

- A-SRAE96 Snap Ring Asst.
Notes: 300 piece assortment

Parts are not Original Equipment parts and are not sponsored, affiliated or otherwise connected with any major brand.

Battery Cables and Terminals



A-C4P	7/32"-5/8" Hose Clamps, 10 Pack
A-C10P	9/16" -1-1/16" Hose Clamp, 10 Pack
A-C6P	7/16"-25/32" Hose Clamp, 10 Pack
A-C12P	11/16"-1-1/4" Hose Clamp, 10 Pack DIM D (4): Packed 10 Per Box (Order 1 To Recieve 10 Pcs.)
A-C16P	13/16"-1 1/2" Hose Clamp, 10 Pack
A-C20P	13/16"-1 3/4" Hose Clamp, 10 Pack DIM D (4): Packed 10 Per Box (Order 1 To Recieve 10 Pcs.)
A-C24P	1-1/16"-2" Hose Clamp, 10 Pack
A-C28P	1-5/16"-2-1/4" Hose Clamp, 10 Pack
A-C32P	1-9/16"-2-1/2" Hose Clamp, 10 Pack
A-C36P	1-13/16"-2-3/4" Hose Clamp, 10 Pack
A-C40P	2 1/16"- 3" Hose Clamp, 10 Pack
A-C44P	2-5/16"-3-1/4" Hose Clamp, 10 Pack
A-C48P	2-9/16"-3-1/2" Hose Clamp, 10 Pack DIM D (4): Packed 10 Per Box (Order 10 To Recieve 10 Pcs.)
A-C56P	3 1/16"-4" Hose Clamp, 10 Pack DIM D (4): Packed 10 Per Box (Order 1 To Recieve 10 Pcs.)



A-CLP11	Clamp, Hose, Wire Type DIM A (1): Adj from 1 7/8" To 2 1/4" PKG QTY: 10
A-CLP13	Clamp, Hose, Wire Type DIM A (1): Adj. From 2" To 2 1/2" PKG QTY: 10



A-14B5401	Hose Clamp Assortment Notes: Counter-wall hopper contains: 20-C4P, 10-C6P, 40-C10P, 10-C16P, 20-C20P, 10-C24P, 10-C36P.
-----------	--



A-14B501	4" Self Locking Nylon Cable Ties Dim/Info: [length]: 4" [width]: .085 [minimum dia.]: 1/16" [maximum dia.]: 3/4" PKG QTY: 100
A-14B502	6" Self Locking Nylon Cable Ties Dim/Info: [length]: 6" [width]: .135 [minimum dia.]: 1/16" [maximum dia.]: 1-1/4" PKG QTY: 100
A-14B505	8" Self Locking Nylon Cable Ties Dim/Info: [length]: 8" [width]: .115 [minimum dia.]: 1/16" [maximum dia.]: 2" PKG QTY: 100
A-14B506	11-1/2" Self Locking Nylon Cable Ties Dim/Info: [length]: 11-1/2" [width]: .190 [minimum dia.]: 1/16" [maximum dia.]: 3" PKG QTY: 100
A-14B507	14-1/2" Self Locking Nylon Cable Ties Dim/Info: [length]: 14-1/2" [width]: .190 [minimum dia.]: 1/16" [maximum dia.]: 4" PKG QTY: 100
A-14B510	33" Self Locking Nylon Cable Ties Dim/Info: [length]: 33" [width]: .310 [minimum dia.]: 3/16" [maximum dia.]: 8" PKG QTY: 25

Parts are not Original Equipment parts and are not sponsored, affiliated or otherwise connected with any major brand.

SHOP SUPPLY

Sealants/ Lubricant/ Anti-Seize

A-11C24 Rad Stop Leak

DIM A (1): Sold in Qty of 24 Tube.
PKG QTY: 24

Notes: Safe in diesel w/ water filters. Mixes w/ all anti-freeze. Seal holds in all pressure systems. Won't clog or cause overheating. Works on aluminum, brass, plastic.

A-VLB4086 Pipe Sealant

DIM A (1): 1.69 fl. oz.

Notes: Pipe sealant plus Teflon, for use on fuel fittings, brake & power steering fittings, oil & coolant lines, hydraulic lines & vacuum hoses.

A-VLB4099 Permanent Pro-Lok High Strength Thread Lock

DIM A (1): 1.69 fl oz bottle

Notes: High strength grade for locking and sealing metal fasteners up to 1" in diameter. Locks nuts, bolts, studs and press-fit assemblies. Seals against leakage and corrosion.

A-VLB4100 Removable Pro-Lock Blue Threadlock

DIM A (1): .20 fl oz Carded Tube

DIM B (2): Removable with hand tools.

DIM C (3): Resists temperatures from -65 - 300°F (-54 - 150°C).
DIM D (4): Formulated to meet the Category requirements of MIL-S-46163A.

DIM E (5): Resistant to gasoline, antifreeze, transmission fluid and oil.
DIM F (6): Prevents galling and corrosion of threads.

Notes: Removable strength blue anaerobic threadlocker for fasteners to 3/4" in diameter. Apply prior to assembly. For locking and sealing carb screws, valve cover bolts, water pump bolts, thermostat bolts, rocker arm adjustment nuts, power tools and more.

A-VLB4101 Permanent Pro-Lok Red Threadlock

DIM A (1): 20 fl oz. Carded Tube

DIM B (2): To remove: Apply heat in excess of 300°F (150°C) to parts to weaken bond.

DIM C (3): Resist temperatures from -65 - 300°F (-54 - 150°C).

DIM D (4): Retains bearings

DIM E (5): Formulated to meet the category requirements of MIL-5-46163A

PKG QTY: 12

Notes: Permanent strength red anaerobic thread locker. Resistant to gasoline, diesel, antifreeze, transmission fluid and oil. Prevents galling and corrosion of threads. Permanently locks and seals metal nuts, bolts, and studs.

A-VLB4102 Gas Tank & Radiator Instant Repair

DIM A (1): .7 oz. Carded Ribbon

DIM B (2): Hardens like steel in 2-4 hrs.

DIM C (3): Full cure in 12 hrs.

PKG QTY: 12

Notes: Easy to use putty which permanently seals small holes, cracks, or split seams without draining or removing the gas tank or radiator.

A-VLB4103 Sleeve Retainer

DIM A (1): 1.69 fl oz bottle

DIM B (2): 3500 psi holding strength

DIM C (3): Resists temperatures from -65 - 450°F (-54 - 232°C)

DIM D (4): Formulated to meet the category requirements of MIL-R-46082B

Notes: Secures Slip & Press Fit Assemblies. High strength anaerobic for locking/ sealing cylinder sleeves and lines, valve guides and bearings, while preventing corrosion. Restores fit to press fit assemblies.

A-VLB4104 Cold Weld Compound

DIM A (1): Double Carded 1 oz Tubes

DIM B (2): Pro Weld (tm)

PKG QTY: 12

Notes: Quick Set Epoxy steel fully cures in 4 minutes to resist temperatures up to 300°F (150°C). Can be drilled, tapped, machined, filed, or sanded. Resistant to gasoline, diesel fuel, oil, water, and antifreeze.

A-VLB4106 Copper XS Hi-Temp RTV Silicone Instant Gasket

DIM A (1): 3 oz Carded Tube

DIM B (2): Resists temperatures from -80 - 700°F (-62 - 370°C).

DIM C (3): Resists oil, transmission fluid, grease, water and antifreeze.

DIM D (4): Will not foul oxygen sensors

PKG QTY: 12

Notes: Low odor, non-corrosive, low Volatile formula especially designed to replace or coat pre-cut gaskets on high performance, turbocharged and 4 cylinder engines. Good adhesion to oily surfaces.

A-VLB4107 Blue XS Advance RTV Silicone Instant Gasket

DIM A (1): 3 oz Carded Tube

DIM B (2): Resists temperatures from -80 - 600°F (-62 - 315°C)

DIM C (3): Resists oil, transmission fluid, grease, water and antifreeze

DIM D (4): Will not foul oxygen sensors

PKG QTY: 12

Notes: Low odor, non-corrosive, low volatile formula designed to replace or coat pre-cut gaskets on high performance engines manufactured after 1980. Good adhesion to oily surfaces.

A-VLB4108 Blue RTV Silicone Instant Gasket

DIM A (1): 3 oz Carded Tube

DIM B (2): Resists high pressure and temperatures from -80 to 600°F (-62 to 315°C)

DIM C (3): Resists oil, transmission fluid, water and antifreeze

PKG QTY: 12

Notes: Low Volatile Formula, Sensor Safe. Replaces most pre-cut gaskets. Won't foul computer sensors. May also be used to coat gaskets for reliable seal

A-VLB4123 Blue RTV Silicone Instant Gasket

DIM A (1): 8 oz Power Can

A-VLB4109 Black RTV Silicone Instant Gasket

DIM A (1): 3 oz Carded Tube

DIM B (2): Resists high pressures and temperatures from -80 - 600°F (-62 - 315°C).

DIM C (3): Resists oil, antifreeze, grease and transmission fluids

DIM D (4): Dries Tough and flexible.

PKG QTY: 12

Notes: Low Volatile Formula, Sensor Safe. Forms gaskets in-place instantly. Replaces cork, paper, asbestos and felt pre-cut gaskets.

A-VLB4110 Clear Silicone Adhesive and Sealant

DIM A (1): Resists oil, transmission fluid, grease, water and antifreeze.

DIM B (2): Withstands temperatures from -70 - 500°F (-60-260°C).

PKG QTY: 12

Notes: Bonds, seals, caulks and insulates. Provides a water proof seal and remains flexible. Used for bonding and sealing glass, metal, leather, vinyl, and rubber. Repair cracked hoses. Seal tail lamps, electrical wires and windows.

Sealants/ Lubricant/ Anti-Seize

A-VLB4111 Red Hi-Temp Silicone Instant Gasket

DIM A (1): 3 oz Carded Tube
DIM B (2): Resists high pressures to 5000 psi
DIM C (3): Resists oil, antifreeze, grease and transmission fluids
DIM D (4): Dries flexible
DIM E (5): Resists shrinkage and cracking.
PKG QTY: 12

Notes: Low Volatile Formula, Sensor Safe. Specially formulated for high temperature applications to 700°F (370°C). Safe for all car models. Won't foul computer sensors.

A-VLB4112 Single .7oz Carded Super Glue

Notes: Bonds instantly with most metals, plastics, ceramics, and rubber.

A-VLB4113 Double .7oz Carded Super Glue

PKG QTY: 2
Notes: Bonds instantly with most metals, plastics, ceramics, and rubber.

A-VLB4122 Gasket Remover

PKG QTY: 12



A-EAS3331 Fluid Film 11 3/4 oz. Aerosol Can

DIM A (1): 11 3/4 oz. Aerosol Can

Notes: Wool-base formula used to give long-term protection, lubrication and stops existing corrosion. Penetrates to free-up heavily seized parts. Always active does not dry out. Will not harm paint, plastic or synthetic rubber.

A-EAS33312 Fluid Film Case Of 12 / 11 3/4 Oz. Aerosol Cans

A-EAS33312 Fluid Film Case Of 12 / 11 3/4 oz. Aerosol Cans

A-EAS33312-CA Fluid Film Case Of 12 / 333 Gram Aerosol Cans (Canada Only)

Notes: Wool-base formula used to give long-term protection, lubrication and stops existing corrosion. Penetrates to free-up heavily seized parts. Always active does not dry out. Will not harm paint, plastic or synthetic rubber.

A-EAS33312 Fluid Film Case Of 12 / 11 3/4 Oz. Aerosol Cans

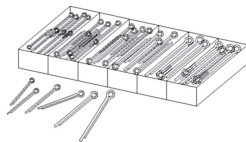

A-VLF3602 Cotter Pin Pack

Notes: Contains 430 pins in sizes from 1/16 x 1" - 5/32 x 2-1/2"



A-ETME150 Digital Caliper

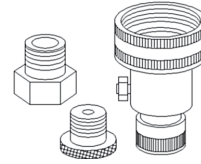

A-5D6 Water Adapter

Notes: Use to connect garden hose coupling to air liquid tractor valves. Includes bushings to fit both external & internal threads.

Parts are not Original Equipment parts and are not sponsored, affiliated or otherwise connected with any major brand.