

NEW ITEMS! NEW ITEMS! NEW ITEMS! NEW ITEMS!



300-27001
Double Yoke, Series 2300 Mfg# 041351
300-27376
Double Yoke, Series 2400 Mfg# 023437



515233811
Clutch Hub 1 3/4-20Z FF4
515223811
Clutch Hub 1/34 4-20Z FF3

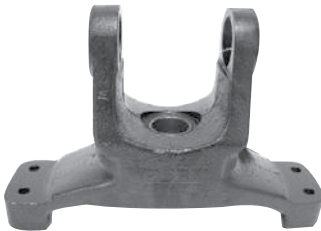

W824A
Flange Yoke, 515233811- Rhino 44R, 8-1/2" C-C



W3081
Flange Yoke, Rhino 35R



Part# 501-0652
Slip Clutch FF4 1 3/4-20Z 6 Series

Slip Clutches



Part# 501-0654
Slip Clutch 1-3/8-6x1-3/8-6 FF4

NEW!
80 Degree Constant Velocity Half Shaft for John Deere® Round Balers

For Models 466, 467, 566, 567
1 3/8-6 Spline Tractor end X
1-11/16-20 Spline Shaft
Replaces OEM No.AE59635

MAP No. 342-3506
Mfg.No. 19503506

- 342-3506**80* Cv 1 3/8-6 Tractor Shaft Half
- 342-3507**80° CV 1-3/8-21 Tractor Shaft Half
- 342-3508**80° CV 1-3/4-20 Tractor Shaft Half
- 342-3509**PTO IMPL 1/2 1-11/16 -20 x 1-3/8-21
- 342-3515**80° CV 1-3/8-6 Tractor Tube Half
- 342-3516**80° CV 1-3/8-6 Tractor Tube Half

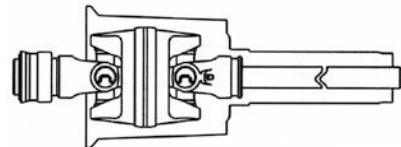



**1 3/8 - 6 SPLINE HUB
2-PLATE SLIP CLUTCH**

PART NO. 401-0184



PARTS BREAKDOWN FOR 401-0184

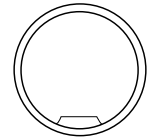
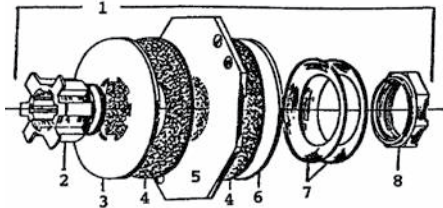

501-0189

Inner Brass Ring for Clutch

Used only in older clutches..... \$20.44

Item	Part No.	Quantity	Description
1.....	401-0184.....	1.....	Slip Clutch
2.....	125-841.....	1.....	Hub.....
3.....	501-0194.....	1.....	Pressure Plate ..
4.....	125-823.....	2.....	Friction Disc
5.....	501-0188.....	1.....	Drive Plate
6.....	501-0186.....	2.....	Pressure Plate ..
7.....	501-0190.....	2.....	Belleville Spring
8.....	125-840.....	1.....	Nut.....



**1 3/8 - 6 SPLINE HUB
4-PLATE SLIP CLUTCH**

PART NO. 401-0195



PARTS BREAKDOWN FOR 401-0195

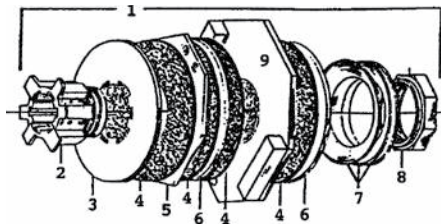

Item	Part No.	Quantity	Description
1.....	401-0195.....	1.....	Slip Clutch
2.....	501-0200.....	1.....	Hub.....
3.....	501-0194.....	1.....	Pressure Plate ..
4.....	125-823.....	4.....	Friction Disc
5.....	501-0188.....	1.....	Pressure Plate ..
6.....	501-0186.....	2.....	Pressure Plate ..
7.....	501-0190.....	2.....	Belleville Spring
8.....	125-840.....	1.....	Nut.....
9.....	501-0197.....	1.....	Drive Plate

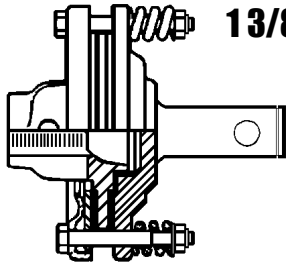

**1 3/8 SMOOTH BORE HUB X 1 3/8 ROUND SHAFT
SLIP CLUTCH**

PART NO. 125-801 2-PLATE



PARTS BREAKDOWN FOR 125-801

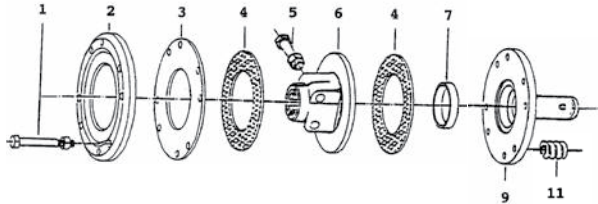

Item	Part No.	Qty	Description
	125-801		Slip Clutch
1	501-0492	1	Bolt & Nut
2	501-0550	1	Pressure Plate
3	501-0551	1	Inner Plate
4	125-811	2	Friction Disc
5	501-0484	1	Bolt, Nut & Washer
6	501-0598	1	Hub 1 ³ / ₈ Round Bore
7	501-0487	1	Collar/Bushing
9	501-0599	1	Flange w/round shaft FDS1
11	125.815	1	Spring

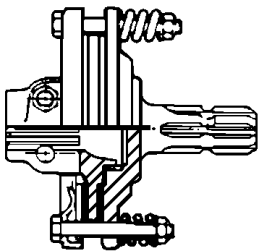

**1 3/8 - 6 SPLINE HUB X 1 3/8 - 6 MALE SHAFT
SLIP CLUTCH**

PART NO. 125-802 2-PLATE



**PARTS BREAKDOWN
FOR 125-802**

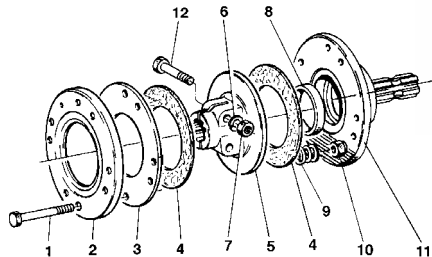

Item	Part No.	Qty	Description
	125-802		Slip Clutch
1	501-0492	1	Spring Bolt & Nut
2	501-0550	1	Outer Pressure Plate
3	501-0551	1	Inner Pressure Plate
4	125-811	2	Friction Disc 140 mm
5	501-0597	1	Female Hub 1 ³ / ₈ 6 Spline
8	501-0487	1	Sleeve
9	125-815	1	Tension Spring
10	125-816	1	Nut (for Spring Bolt)
11	125-817	1	Splined Shaft Plate
12	501-0484	1	Taper Bolt/Nut

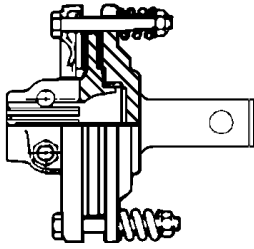

**1 3/8 - 6 SPLINE HUB X 1 3/8 ROUND SHAFT
SLIP CLUTCH**

PART NO. 125-803 2-PLATE

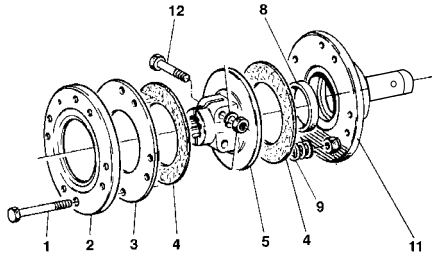

**PARTS BREAKDOWN
FOR 125-803**

Item	Part No.	Qty	Description
	125-803		Slip Clutch
1	501-0492	1	Spring Bolt
2	501-0550	1	Outer Pressure Plate
3	501-0551	1	Inner Pressure Plate
4	125-811	2	Friction Disc 140 mm (BFD13)
5	501-0597	5	Female Hub 1 3/8 6 Spline
8	501-0487	1	Sleeve
9	125-815	1	Tension Spring
11	125-818	1	Smooth Shaft Plate
12	501-0484	1	Bolt

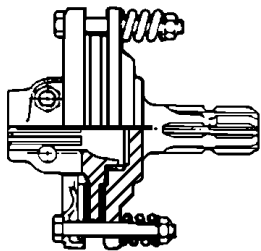

**1 3/8 - 6 SPLINE SHAFT X 1 3/8 -21 SPLINE HUB
SLIP CLUTCH**

PART NO. 125-805 2-PLATE

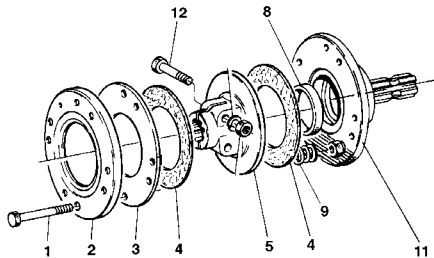

**PARTS BREAKDOWN
FOR 125-805**

Item	Part No.	Qty	Description
	125-805		Slip Clutch
1	501-0492	1	Spring Bolt & Nut
2	501-0550	1	Outer Pressure Plate
3	501-0551	1	Inner Pressure Plate
4	125-811	2	Friction Disc 140 mm
5	501-0597-21	1	Female Hub 1 3/8 21 Spline
8	501-0487	1	Sleeve
9	125-815	1	Tension Spring
11	501-0599	1	Splined Shaft Plate
12	501-0484	1	Bolt

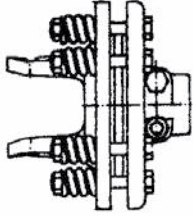

**1 3/8 - 6 SPLINE HUB X SERIES 4 FF1
SLIP CLUTCH**

PART NO. 501-0590 2-PLATE



**PARTS BREAKDOWN
FOR 501-0590**

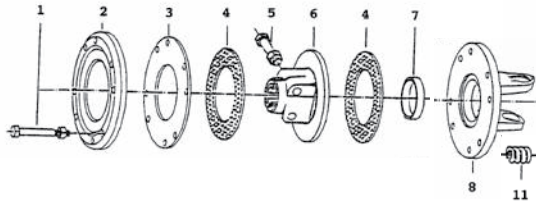

Item	Part No.	Qty	Description
	501-0590		Slip Clutch
1.....	501-0492	1.....	Bolt & Nut
2.....	501-0550	1.....	Pressure Plate
3.....	501-0551	1.....	Inner Plate
4.....	125-811	2.....	Friction Disc
5.....	501-0484	1.....	Bolt, Nut & Washer
6.....	501-0597	1.....	Hub 1 ^{3/8} - 6Z
7.....	501-0487	1.....	Collar/Bushing
8.....	253042001	1.....	Flange Yoke
11.....	125-815	1.....	Spring

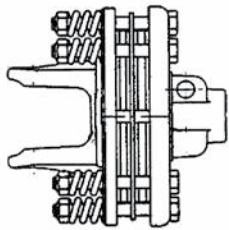

**1 3/8 - 6 SPLINE HUB X SERIES 6 FF3
SLIP CLUTCH**

PART NO. 501-0547



PARTS BREAKDOWN FOR 501-0547

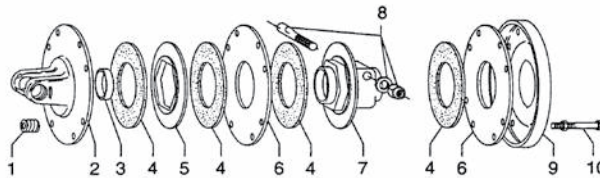

Item	Part No.	Quantity	Description
	501-0547		Slip Clutch
1.....	125-815	8.....	Spring
2.....	501-0555	1.....	Flange Yoke - 6
3.....	501-0487	1.....	Collar
4.....	125-811	4.....	Friction Disc
5.....	501-0554	1.....	Lining Plate
6.....	501-0551	2.....	Inner Plate
7.....	501-0548	1.....	Hub 1 ^{3/8} - 6
8.....	501-0484	1.....	Taper Bolt 1 ^{3/8} - 6
9.....	501-0550	1.....	Pressure Plate
10.....	501-0549	8.....	Bolt & Nut

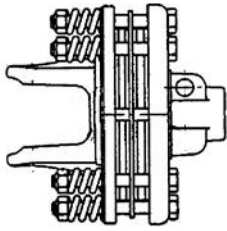

1 3/4 - 20 SPLINE X SERIES 8 FF4 SLIP CLUTCH

PART NO. 501-0650

PARTS BREAKDOWN FOR 501-0650

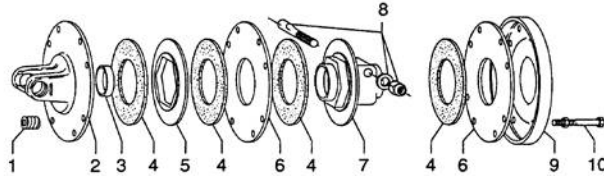

<u>Item</u>	<u>Part No.</u>	<u>Quantity</u>	<u>Description</u>
	501-0650		Slip Clutch
1.....	125-815.....	8.....	Spring.....
2.....	253082302.....	1.....	Flange Yoke - 8.....
3.....	501-0487.....	1.....	Collar.....
4.....	125-820.....	4.....	Friction Disc.....
5.....	275230004.....	1.....	Lining Plate.....
6.....	501-0490.....	2.....	Inner Plate.....
7.....	515233811.....	1.....	Hub 1 ^{3/4} - 20.....
8.....	501-0531.....	1.....	Taper Bolt 1 ^{3/4} - 20.....
9.....	501-0491.....	1.....	Pressure Plate.....
10.....	501-0549.....	8.....	Bolt & Nut.....

1 3/4 - 20 SPLINE X SERIES 6 FF4 SLIP CLUTCH

PART NO. 501-0652

PARTS BREAKDOWN FOR 501-0652

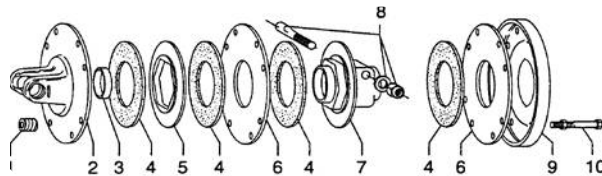
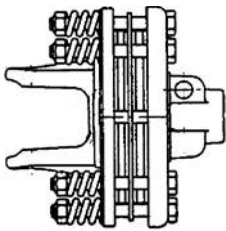

<u>Item</u>	<u>Part No.</u>	<u>Quantity</u>	<u>Description</u>
	501-0652		Slip Clutch
1.....	125-815.....	8.....	Spring.....
2.....	501-0486.....	1.....	Flange Yoke - 6.....
3.....	501-0487.....	1.....	Collar.....
4.....	125-820.....	4.....	Friction Disc.....
5.....	275230004.....	1.....	Lining Plate.....
6.....	501-0490.....	2.....	Inner Plate.....
7.....	515233811.....	1.....	Hub 1 ^{3/4} - 20.....
8.....	501-0531.....	1.....	Taper Bolt 1 ^{3/4} - 20.....
9.....	501-0491.....	1.....	Pressure Plate.....
10.....	501-0549.....	8.....	Bolt & Nut.....

**1 3/8 - 6 SPLINE X SIZE 6 FF2
SLIP CLUTCH**

PART NO. 343-802

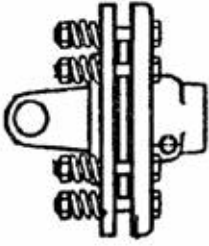

PARTS BREAKDOWN FOR 343-802

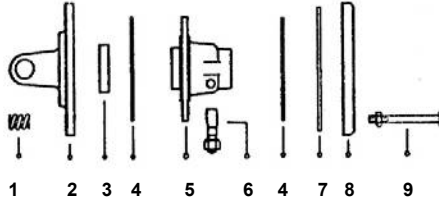

<u>Item</u>	<u>Part No.</u>	<u>Quantity</u>	<u>Description</u>
	343-802		Slip Clutch
1.....	125-815.....	8.....	Spring.....
2.....	501-0486.....	1.....	Flange Yoke
3.....	501-0487.....	1.....	Collar.....
4.....	125-820.....	2.....	Friction Disc 160mm OD.....
5.....	501-0489.....	1.....	Hub 1-3/8" 6 Spline.....
6.....	501-0484.....	1.....	Taper Bolt.....
7.....	501-0490.....	1.....	Inner Plate.....
8.....	501-0491.....	1.....	Pressure Plate
9.....	501-0492.....	8.....	Bolt & Nut.....

**1 3/8 - 6 SPLINE X SERIES 8 FF4
SLIP CLUTCH**

PART NO. 343-803

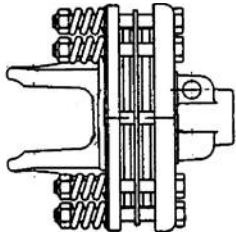

PARTS BREAKDOWN FOR 343-803

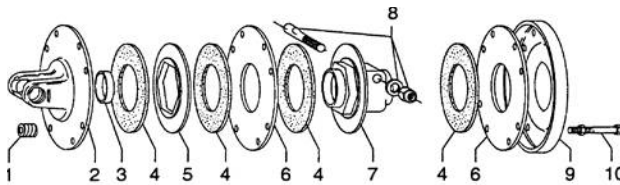

<u>Item</u>	<u>Part No.</u>	<u>Quantity</u>	<u>Description</u>
	343-803		Slip Clutch
1.....	125-815.....	8.....	Spring.....
2.....	253082302.....	1.....	Flange Yoke - 8... ..
3.....	501-0487.....	1.....	Collar.....
4.....	125-820.....	4.....	Friction Disc
5.....	275230004.....	1.....	Lining Plate
6.....	501-0490.....	2.....	Inner Plate.....
7.....	515230311.....	1.....	Hub 1 3/8 - 6
8.....	501-0484.....	1.....	Taper Bolt 1 3/8 - 6
9.....	501-0491.....	1.....	Pressure Plate
10.....	501-0549.....	8.....	Bolt & Nut.....

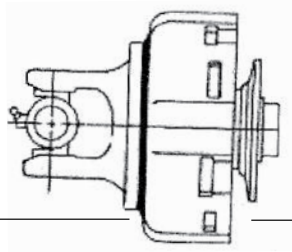

1 3/8 - 6 SPLINE HUB X 2400 SERIES FLANGE SLIP CLUTCH

Mfg. by Walterscheid

PART NO. 501-0351 4-PLATE



PARTS BREAKDOWN FOR 501-0351

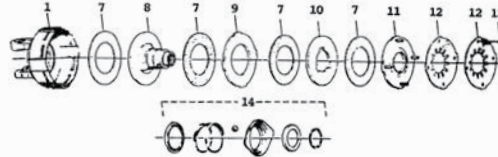

<u>Item</u>	<u>Part No.</u>	<u>Quantity</u>	<u>Description</u>
	501-0351		Slip Clutch
1.....	501-0363.....	1.....	Clutch Housing.....
7.....	125-822.....	4.....	Friction Disc
8.....	501-0365.....	1.....	Hub 1 3/8 " 6 Spline
9.....	501-0367.....	1.....	Drive Plate
10.....	501-0368.....	1.....	Drive Plate
11.....	501-0369.....	1.....	Thrust Plate.....
12.....	501-0370-W.....	1.....	Belleville Spring
12.....	501-0370-R.....	1.....	Belleville Spring
13.....	501-0371.....	4.....	Nut 8mm
14.....	801-0377.....	1.....	Lock Kit

Slip Clutch Replacement Discs

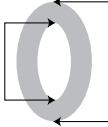
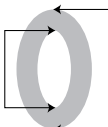
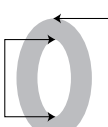
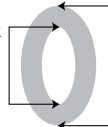
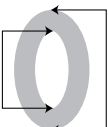
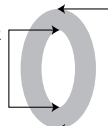
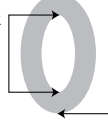
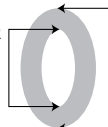
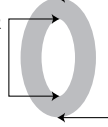
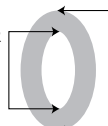
125-811	REPLACES OEM NUMBERS: BUSH HOG CLUTCH PLATE 64651 BONDIOLI 247000054 AGMATE 31953	INSIDE DIAMETER 85MM		OUTSIDE DIAMETER 140MM
125-820	REPLACES OEM NUMBERS: BUSH HOG CLUTCH PLATE 64644 BONDIOLI 247000011 BONDIOLI 247000061 AGMATE 31971	INSIDE DIAMETER 96MM		OUTSIDE DIAMETER 160MM
125-821	REPLACES THE OEM NUMBER: RHINO CLUTCH PLATE 058-1060-003	INSIDE DIAMETER 3.813"		OUTSIDE DIAMETER 7"
125-822	REPLACES OEM NUMBERS: RHINO CLUTCH PLATE 754202 JOHN DEERE W34913 JOHN DEERE DY10734 BUSH HOG 76083	INSIDE DIAMETER 91 MM		OUTSIDE DIAMETER 153MM
125-823	REPLACES OEM NUMBERS: FORD 222042 TERRAIN KING 748833 HARDEE C57 SIDEWINDER 15436 MASSEY 1045320M1 CALDWELL 8323 HOWSE HOTL12	INSIDE DIAMETER 2.625"		OUTSIDE DIAMETER 6.5"
125-824	REPLACES OEM NUMBERS: JOHN DEERE 39301	INSIDE DIAMETER 4.5"		OUTSIDE DIAMETER 6.5"
125-825	REPLACES OEM NUMBER: WOODS 7280 VERMEER 106416017	INSIDE DIAMETER 4"		OUTSIDE DIAMETER 6.25"
125-826	REPLACES OEM NUMBER: BUSH HOG 372-1BH	INSIDE DIAMETER 2.4"		OUTSIDE DIAMETER 6.5"
125-828	REPLACES OEM NUMBERS: FORD 202227 NEW HOLLAND 1222119 CALDWELL 3059	INSIDE DIAMETER 2"		OUTSIDE DIAMETER 6-1/2"
125-834	REPLACES OEM NUMBER: BUSH HOG 374BH	INSIDE DIAMETER 1.125"		OUTSIDE DIAMETER 6.5"

FLEXIBLE COUPLING DISC

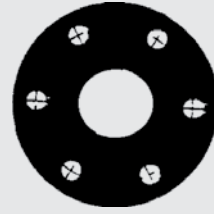

Part NO. 340-1903

Replaces Servis No: 68-109-4 & 00-749172
Dia: 6" / Thickness: 3/8"
Hole Dia: 5/8 (with 6 holes)

Part NO. 340-1913

Replaces Servis No: 762215
Dia: 6-5/16" / Thickness: 23/32"
Hole Dia: 7/8 (with 6 holes)

JACKSHAFT

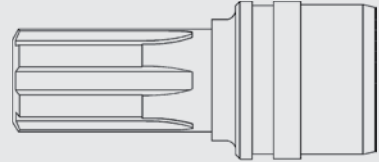

**PART NO.
340-1909**

DESCRIPTION
1-3/8" 6 spline stub shaft.
Replaces Servis - Rhino # 037-1290-301

BUSH HOG STUB SHAFT

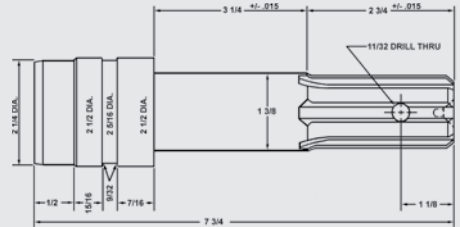

**PART NO.
340-1912**

DESCRIPTION:
Stub shaft 1 3/8 6 spline

Replaces: 62877
Models: 315 Early, 126, 109 & 307

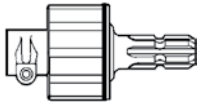

Eurocardan overrunning clutch provide a safe way to protect operators and machinery where inertia units: i.E. Rotary mowers, balers, hay conditioners, etc. Can overrun driving source. They feature a quick detach pin to quickly disconnect from the unit. They take the push out of the driven machine and eliminate the chance of broken or twisted P.T.O. Shafts. Overrunning clutch drive solidly from tractor to driven implement, but overrun smoothly when implement exceeds P.T.O. Speeds.

Part No.	Description	Tractor
335-660	Overrunning clutch w/ quick detach...	1 3/8 to 1 3/8.....
335-670	Overrunning clutch w/ quick detach...	1 3/8 to 1 1/8.....

HUB CITY OVERRUNNING COUPLERS

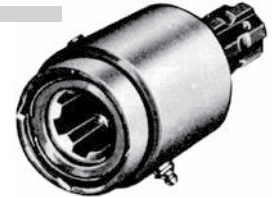

- All steel welded housing
- Heat treated alloy steel inner sleeve
- Hardened steel keys, spring loaded
- Snap ring construction for quick, easy disassembly for cleaning & service
- 5/16" X 2" spring rollpin for quick mounting to tractor
- Convenient grease fitting for gun lubrication
- Designed to operate with 1000 rpm p.T.O.'S •Shipping weight 6 lbs.

PART NO.	FEMALE SPLINE	MALE SPLINE	EXTENDS PTO LENGTH	FITS TRACTOR	
331-690	1-1/8 - 6	1-1/8 - 6	6-21/32	4-19/32	All with cross pin hole including Ford
641-453	Roll Pin - 5/16" X 2" \$0.44				

HUB CITY - Overrunning couplers provide a safe way to protect operators and machinery where inertia units: i.e. rotary mowers, balers, hay conditioners, etc. can overrun driving source. They take the push out of the driven machine and eliminate the chance of broken or twisted P.T.O. shafts. Overrunning couplers drive solidly from tractor to driven implement, but overrun smoothly when implement exceeds P.T.O. speeds. **INSTALLATION AND LUBRICATION INSTRUCTIONS ENCLOSED WITH EACH COUPLER.**

MODERN OVERRUNNING COUPLERS UP-TO 75 HP

- The best PTO adapter value available
- Proven quality for today's toughest applications

Over-running clutch extender; designed to "free wheel" smoothly when implement exceeds tractor's speed; maximum 1000 RPM operating speed.

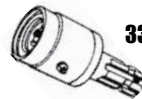

334-660



334-670

PART NO.	MFG. NO.	FEMALE SPLINE	MALE SPLINE	EXTENDS PTO	OVERALL LENGTH	MAX H.P.	WEIGHT LBS.
334-660	SP16630	1-3/8" X 6	1-3/8" X 6	3-13/16"	6-1/2"	75	5.0
334-670	SP16631	1-1/8" X 6	1-3/8" X 6	3-13/16"	6-1/2"	75	5.0

PTO ADAPTERS

Splined Adapters - to 125 H.P.

- Capacity to operate on tractors rated to 125 P.T.O. horsepower
- Developed for long and rugged use
- Alloy steel, heat treated for extra strength
- Withstands high shock loads from tractor or implement
- Parco-lubricated rust preventative finish
- Cross pins or setscrews furnished



PART NO.	FEMALE SPLINE	MALE SPLINE	LENGTH	EXTENDS PTO	SECURED BY
332-2	1-3/8 - 21	1-3/8 - 6	6-7/8	4-13/16	Setscrew....

PART NO.	FEMALE SPLINE	MALE SPLINE	LENGTH	SPECIAL APPLICATION
332-355	31/32-10	1-3/8 - 6	2-1/4	IHC Cub & Kubota.....
332-352	1-1/8 - 6	1-3/8 - 6	2-1/4	No Special Application.....
332-363	1-1/8 - 6	1-3/8 - 6	2	Replaces Ford 231082.....
641-453	PTO Roll Pin - 5/16" X 2"			

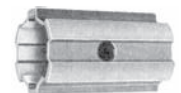

HUB CITY PTO ADAPTERS

**"FORGED" P.T.O. ADAPTER
TO 75 H.P.**

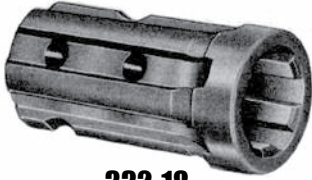

332-18

- 1 1/8-6 Spline Female - 1 3/8- 6 Spline Male.
- "Forged" Internal Spline
- Universal Quick-Detach Slot And Bolt Holes -Can Be Used With Any American, British Or European P.T.O. System
- Furnished With 5/16 X 1 1/16 Spring Pin For Direct Connection To P.T.O.
- Overall Length: 3- Extends P.T.O. 1 1/8

HUB CITY KWIK-D-TACH SPLINE ADAPTERS - TO 75 H.P.

- Capacity to operate on tractors rated to 75 P.T.O. Horsepower
- Patented quick release device
- New p.T.O. Quick release concept - spring Loaded - rotates about 30° by hand for quick Release
- Dependable operation - no sticking pins. Always easily operated
- No sharp edges, protrusions, pin or Interferences to injure operators.



**332-1375
332-92**



**332-10
332-13
332-15**

PATENT NO. 3936532

PART NO.	FEMALE SPLINE	MALE SPLINE	LENGTH	EXTENDS PTO
332-10	1-3/8 - 6	1-3/8 - 6	6-1/2	4-5/16
332-13	1-3/8 - 6	1-3/8 - 21	6-1/2	4-5/16
332-15	1-3/8 - 6	1-1/8 - 6	6-1/2	4-5/16
332-1375	1-3/8 - 21	1-3/8 - 6	6-1/2	4-5/16
332-92	1-3/8 - 6	1-3/8 - 21	6-1/2	4-5/16

HUB CITY HEAVY-DUTY SPLINED ADAPTERS

FOR TRACTORS WITH 1 3/4-20 SPLINE P.T.O.



**332-20
332-21**

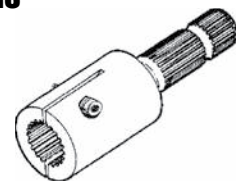

**332-1476
332-1477
332-1490
332-1491**

PART NO.	FEMALE SPLINE	MALE SPLINE	LENGTH	H.P. RATING	EXTENDS PTO	SECURED BY
332-20	1-3/4-20	1-3/8 - 6	8-3/16	75	4-15/16	Setscrew
332-21	1-3/4-20	1-3/8 - 21	8-3/16	75	5-7/16	Setscrew
332-1476*	1-3/4-20	1-3/8 - 6	8-3/16	75	4-15/16	Clamp Type
332-1477*	1-3/4-20	1-3/8 - 21	8-3/16	75	5-7/16	Clamp Type
332-1490	1-3/4-20	1-3/8 - 6	8-3/16	125	4-15/16	Clamp Type
332-1491	1-3/4-20	1-3/8 - 21	8-3/16	125	4-15/16	Clamp Type

641-453 PTO Roll Pin - 5/16" X 2"

* For applications using our standard 03-32-00020 and 03-32-00021 adaptors where heavy overhung load is a factor such as P.T.O. mounted pumps, etc.



SPLINED ADAPTERS - 75 H.P.

- Capacity to operate on tractors rated to 75 P.T.O. Horsepower
- Provide a means of connecting two dissimilar spline.
- Welded-steel construction for added strength.
- Parco-lubricated rust preventative finish
- Cross pins or setscrews furnished

Part No.	Female Spline	Male Spline	Length	Extends PTO	Secured By
*332-3531	1-1/8-6	1-3/8-6	5-1/2	3-9/16	Cross Pin
*332-354	1-1/8-6	1-3/8-6	5-9/16	4-1/8	Cross Pin
*332-400	1-3/8-6	1-1/8-6	6-1/2	4-9/16	Cross Pin
*332-420	1-3/8-6	1-1/8-6	5-1/8	2-13/16	Cross Pin
*332-371	1-3/8-6	1-3/8-6	6-1/2	4-9/16	Cross Pin
*332-378	1-3/8-6	1-3/8-6	5-1/8	2-15/16	Cross Pin
332-373	1-3/8-21	1-3/8-6	6-1/2	4-1/2	Setscrew
332-375	1-1/8-6	1-3/8-6	10-1/2	8-13/16	Cross Pin
332-70	1-3/8-21	1-3/4-20	7	5	Setscrew

* P.T.O. PIN SOLD SERARATELY 641-453

HUB CITY KWIK-D-TACH SPLINED PUMP DRIVE ADAPTERS

Same, Safe, Dependable Fast Action Release As Kwik-D-Tach Splined Adapters

Part No.	Female Spline	Female Round	Keyway	Length
332-11	1-3/8 - 6	0.875	3/16 X 3/32	4-13/32

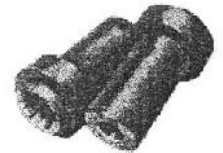

HUB CITY SPLINED PUMP DRIVE ADAPTERS

P.T.O. Pin Included With All 1 1/8-6 Spline And 1 3/8-6 Spline Pump Drives.
1 3/8-21 Spline And 1 3/4-27 Spline Pump Drives Are Supplied With Setscrews.

Part No.	Female Spline	Female Round	Keyway	Length
332-407	1-3/8 - 6	0.625	3/16 X 3/32	4-11/32
332-408	1-3/8 - 6	0.750	3/16 X 3/32	4-11/32
332-409	1-3/8 - 6	0.875	1/4X1/8	4-11/32
332-410	1-3/8 - 6	1.00	1/4X1/8	4-11/32



Round Handle

PART NO.	PIN DIA	USABLE LENGTH
156-517	1/4"	2-1/4"
156-518	5/16"	2-1/4"
156-519	3/8"	3"

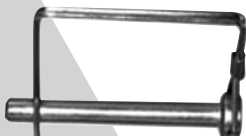

Square Handle

PART NO.	PIN DIA	USABLE LENGTH
156-516	5/16"	2-1/4"

Numerous farm, lawn and garden and industrial applications. Round and square loops. Yellow zinc dichromate plated.

OVER RUNNING COUPLERS/PTO ADAPTERS

- The best PTO adapter value available
- Proven quality for today's toughest applications

Part#	Mfg#	Description	(F) Spline	(M) Spline	Extends PTO	Overall Length	Max H.P.	Wgt
334-660	SP16630	Over-running clutch extender; designed to "free wheel" smoothly when implement exceeds tractor's speed; maximum 1000 RPM operating speed.	1-3/8" X 6	1-3/8" X 6	3-13/16"	6-1/2"	75	5.0
334-670	SP16631	Over-running clutch increaser; designed to "free wheel" smoothly when implement exceeds tractor's PTO speed, maximum 1000 RPM operating speed.	1-1/8" X 6	1-3/8" X 6	3-13/16"	6-1/2"	75	5.0
334-363	SP1660	Sleeve increaser; Ford 231082	1-1/8" X 6	1-3/8" X 6	0	2"	75	0.2
334-352	SP1662	Sleeve increaser; fits all tractors except Ford	1-1/8" X 6	1-3/8" X 6	0	2-1/4"	75	0.2
334-373	SP1663	PTO spline adapter; converts 21-spl 1000 RPM to 6 spl 540 RPM	1-3/8" X 21	1-3/8" X 6	3-1/4"	5-7/8"	75	2.0
334-400	SP1664	Universal reducer	1-3/8" X 6	1-1/8" X 6	3-5/16" approx.	5-1/8"	75	1.4
334-3531	SP1665	PTO increaser	1-1/8" X 6	1-3/8" X 6	3-5/8" approx.	5-1/2"	75	1.3
334-18	SP1666	PTO increaser	1-1/8" X 6	1-3/8" X 6	1-1/8" approx.	3-1/4"	75	0.6
334-20	SP1667	PTO spline adapter, 20 to 6 spl; set screw lock	1-3/4" X 20	1-3/8" X 6	4-5/8" approx.	7-1/8"	75	6.1
334-378	SP1668	PTO extender	1-3/8" X 6	1-3/8" X 6	3-5/16" approx.	5-1/8"	75	2.2
334-1375	SP16610	PTO spline adapter with quick release, converts 21 spline 1000 RPM to 6 spline 540 RPM	1-3/8" X 21	1-3/8" X 6	3-7/8"	6-1/2"	75	2.5
334-13	SP16611	PTO spline adapter; quick release; converts 6 spline 540 RPM to 21 spline 1000 RPM	1-3/8" X 6	1-3/8" X 21	4-1/8" approx.	6-1/2"	75	2.5
334-10	SP16612	PTO extender; quick release	1-3/8" X 6	1-3/8" X 6	4-3/8"	6-1/2"	75	2.8
334-21	SP16615	PTO spline adapter; 20 to 21 spline; set screw	1-3/4" X 20	1-3/8" X 21	4-5/8"	7"	75	4.2



334-363



334-352



334-400



334-3531



334-18



334-20



334-378

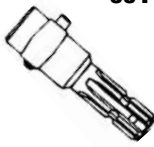

334-1375



334-13

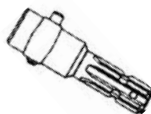

334-10



334-21



334-660



334-670