

PTO Parts

A-81819791 Arm, Drive Clutch Actuating 0.1 Lbs.



For Models: 5000, 5100, 5110, 5190, 5200, 5340, 5600, 5610, 5640, 5700, 5900, 6410, 6600, 6610, 6640, 6700, 6710, 6810, 7000, 7010 SN 850001>, 7200, 7410, 7600, 7610, 7700, 7710, 7740, 7810, 7840, 7910, 8000, 8010 SN 850001>, 8200, 8210, 8240, 8340, 8400, 8600, 8670, 8700, 8770, 8870, 8970, 9000, 9200, 9600, 9700, TB100, TB110, TB120, TM115, TM120, TM125, TM130, TM135, TM140, TM150, TM155, TM165, TM175, TM190, TS100, TS110, TS115, TS90

A-E0NNB726AB PTO Brake Band 0.15 Lbs.



For Models: TW10, TW20, 5100, 5110, 5600, 5610, 5640, 5900, 6410, 6600, 6610, 6640, 6700, 6710, 6810, 7100, 7600, 7610, 7700, 7710, 7740, 7910, 8000, 8210, 8700, 9600, 9700, (5000, 6000, 7000 ALL W/ SINGLE OR DUAL SPEED)

A-D3NNP733A PTO Feathering Spring (Std.) 0.16 Lbs.

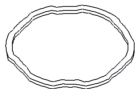

For Models: TW15, TW25, TW35, TW5, 6410, 6810, 7410, 7910, 8000, 8200, 8210, 8530, 8600, 8700, 8730, 8830, 9000, 9200, 9600, 9700, (5600, 5610, 6600, 6610, 6700, 6710, 7600, 7610, 7700, 7710 ALL W/ SINGLE OR TWO SPEED PTO), (5000, 7000 ALL W/ SINGLE OR TWO SPEED PTO 1965>)

A-CONN7A548A PTO Clutch Piston Outer Seal 0.03 Lbs.

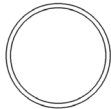

For Models: TW10, TW15, TW20, TW25, TW30, TW35, TW5, 5000, 6000, 7000, 8000, 9000, 4000 1965>

A-373227S PTO Clutch Piston Inner Seal 0.01 Lbs.

Dim/Info:
sold in multiples of 2



For Models: TW10, TW15, TW20, TW25, TW30, TW35, TW5, 5000, 6000, 7000, 8000, 9000, 4000 1965>

A-C7NNB742A PTO Clutch Actuating Arm 0.57 Lbs.

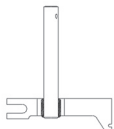

For Models: 8000, 8200, 8400, 8600, 8700, 9000, 9200, 9600, 9700

A-313283 PTO Clutch Piston Ring 0.1 Lbs.



For Models: (4100, 4600 ALL W/ INDEPENDENT PTO 1975-1981), (4110, 4610 ALL W/ INDEPENDENT PTO 1981>), 4000 W/ INDEPENDENT PTO 4/1968 - 1975, (5600, 5700, 6600, 6700, 7600, 7700 ALL W/ SINGLE OR 2 SPEED PTO <1975), (5000, 7000 ALL W/ SINGLE SPEED PTO 1965-1975, W/ 2 SPEED PTO 6/1973-1975), (8000, 9000 ALL 1968>), (5610, 6610, 6710, 7610, 7710 ALL 1981>)

A-C9NNN747A Brake Arm, PTO Clutch 0.16 Lbs.

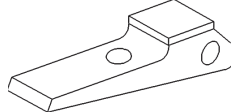

For Models: 340, 445, 532, 540, 545, 3055, 3910, 4000, 4100, 4110, 4140, 4410, 4600, 4610

A-C9NNN747B Brake Arm, PTO Drive 0.14 Lbs.

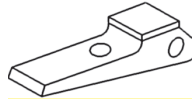

For Models:

A-81827441* Valve, PTO Drive Clutch 0.6 Lbs.

Replaces: C7NNN700C, D2NNN700B

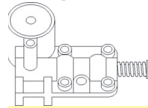

For Models: 5000, 5100, 5190, 5200, 5340, 7000, 7100, 7200

A-D2NNN776A PTO Drive Clutch Valve Support 0.7 Lbs.

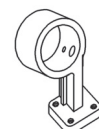

For Models: (5600, 5700, 6600, 6700, 7600, 7700 ALL W/ SINGLE SPEED PTO 1975-81), (5610, 5900, 6610, 6710, 7610, 7710 ALL W/ SINGLE SPEED PTO 1981-91), (5000, 7000 ALL W/ SINGLE SPEED PTO 6/73>)

A-C7NNN776C PTO Drive Clutch Valve Support 0.69 Lbs.



For Models: (5000, 7000 ALL FOR SINGLE SPEED PTO 1/65-5/73)

A-C7NNB787A PTO Drive Clutch Valve Support 2.56 Lbs.

For Models: 8000, 8200, 8400, 8600, 8700, 9000, 9200, 9600, 9700

A-C5NN799A Oil Seal, PTO Input Shaft 0.03 Lbs.



For Models: (5000, 7000 ALL W/ 7 & 8 SPEED TRANSMISSIONS), (5600, 5610, 6600, 6610, 6700, 6710, 7600, 7610, 7700, 7710 ALL W/ 8 SPEED TRANSMISSION)

A-957E727A Oil Seal, PTO Input Shaft 0.02 Lbs.



For Models: DEXTA, SUPER DEXTA, (2000, 3000, 4000 ALL W/ 6, 7 & 8 SPEED TRANSMISSIONS), (2610, 3610, 4100, 4110, 4600, 4610 ALL W/ 8 SPEED TRANSMISSION)

A-D9NN7048BA Oil Seal, PTO Input Bearing Retainer 0.02 Lbs.

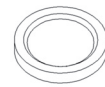

For Models: (5000, 7000 ALL W/ 7 & 8 SPEED TRANSMISSIONS), (5600, 5610, 6600, 6610, 6700, 6710, 7600, 7610, 7700, 7710 ALL W/ 8 SPEED TRANSMISSION)

AGCO
ALLIS
CHALMERS
DEUTZ
MASSEY
FERGUSON
WHITE/
OLIVER

CNH

CASE-IH

FORD / NEW
HOLLAND

FIAT

BELARUS

BOBCAT

JCB

JOHN
DEERE

KUBOTA

LANDINI

LEYLAND

LONG

McCORMICK

OTHER

RENAULT

SAME

VALTRA

VERSATILE

YANMAR

ZETOR

SCHWARTZ
SPEECO

*** Truck icon indicates the item is shipped via truck freight.***

PTO Parts

A-D9NNC729BA Seal, PTO Input Bearing Retainer 0.1 Lbs.



AGCO
ALLIS
CHALMERS
DEUTZ
MASSEY
FERGUSON
WHITE/
OLIVER

For Models: 2000 W/ 6, 7, OR 8 Speed Trans. W/ Live/Indep. PTO, 2600 W/ 6 OR 8 Speed Trans. W/ Live/Indep. PTO, 2610 W/ 8 Speed Trans., 3000 W/ 6, 7, OR 8 Speed Trans. W/ Live/Indep. PTO, 3600 W/ 6 OR 8 Speed Trans. W/ Live/Indep. PTO, 3610 W/ 8 Speed Trans., 4000 W/ 6, 7, OR 8 Speed Trans. W/ Live/Indep. PTO, (4100, 4110, 4600, 4610 ALL W/ 8 Speed Trans.), SUPER DEXTA W/ Live/Indep. PTO

A-81819531* Plate, PTO Shift 0.5 Lbs.



For Models: 231, 233, 234, 333, 334, 335, 340, 340A, 340B, 420, 445, 445A, 455, 515, 531, 532, 535, 540, 540A, 540B, 545, 545A, 2000 1965>, 2100, 2110, 2120, 2150, 2300, 2310, 2600, 2610, 2810, 2910, 3000, 3055, 3100, 3110, 3120, 3150, 3190, 3300, 3310, 3330, 3400, 3600, 3610, 3910, 4000 1965>, 4100, 4110, 4140, 4190, 4200, 4330, 4340, 4400, 4410, 4500

A-81819532* Arm, PTO Shift 0.5 Lbs.

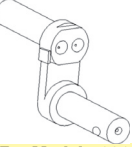

CNH
CASE-IH
FORD / NEW
HOLLAND

For Models: 231, 233, 234, 333, 334, 335, 340, 340A, 340B, 420, 445, 445A, 455, 515, 531, 532, 535, 540, 540A, 540B, 545, 545A, 2000 1965>, 2100, 2110, 2120, 2150, 2300, 2310, 2600, 2610, 2810, 2910, 3000, 3055, 3100, 3110, 3120, 3150, 3190, 3300, 3310, 3330, 3400, 3600, 3610, 3910, 4000 1965>, 4100, 4110, 4140, 4190, 4200, 4330, 4340, 4400, 4410, 4500

A-C5NN723A* Lever, PTO Shift 0.85 Lbs.



BELARUS
BOBCAT
JCB

For Models: 231, 233, 234, 333, 334, 335, 340, 340A, 340B, 515, 531, 532, 2000 1965>, 2100, 2110, 2120, 2150, 2300, 2310, 2600, 2610, 2810, 2910, 3000, 3055, 3100, 3110, 3120, 3150, 3190, 3300, 3310, 3330, 3400, 3600, 3610, 3910, 4000 1965>, 4100, 4110, 4140, 4190, 4200, 4330, 4340, 4400, 4410, 420, 445, 445A, 4500, 455, 515, 535, 540, 540A, 540B, 545, 545A

A-81801836* Fork, PTO Shift 0.5 Lbs.

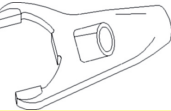

LANDINI
LEYLAND
LONG

For Models: 231, 233, 234, 333, 334, 335, 340, 340A, 340B, 420, 445, 445A, 455, 515, 531, 532, 535, 540, 540A, 540B, 545, 545A, 2000 1965>, 2100, 2110, 2120, 2150, 2300, 2310, 2600, 2610, 2810, 2910, 3000, 3055, 3100, 3110, 3120, 3150, 3190, 3300, 3310, 3330, 3400, 3600, 3610, 3910, 4000 1965>, 4100, 4110, 4140, 4190, 4200, 4330, 4340, 4400, 4410, 4500

A-D9NN703BB PTO Seal 0.1 Lbs.



McCORMICK
OTHER
RENAULT
SAME
VALTRA

For Models: 2600, 2610, 3600, 3610, 4000, 4100, 4110, 4600, 4610, (2000, 3000 ALL W/ 4, 6, 7 OR 8 SPEED TRANSMISSION)

A-C5NN798A Bushing, PTO Drive Shaft Front 0.4 Lbs.

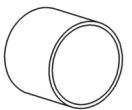

VERSATILE
YANMAR
ZETOR

For Models: (5000 SERIES, 6000 SERIES, 7000 SERIES ALL W/SINGLE SPEED PTO)

SCHWARTZ
SPEECO

A-D1NN772B Shaft, PTO Input 5.12 Lbs.

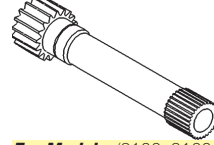

For Models: (2100, 3100, 3400, 3500, 4400, 4500 ALL W/ MAN. REVERSE TRANS.)

A-E75GE9 Bearing, PTO Front 0.63 Lbs.



A-314267 Snap Ring, PTO Front Bearing 0.01 Lbs.

For Models: (2000, 4000, 600, 700, 800, 900 ALL W/ 1.375" DIA. PTO)

A-9N735B PTO Shaft Sleeve 0.31 Lbs.

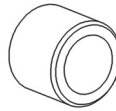

For Models: (2N, 600, 700, 8N, 800, 9N, 900)

A-NAA798A Thrust Bushing, PTO Shaft 0.4 Lbs.

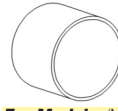

For Models: (NAA, 2000, 4000, 600, 700, 800, 900 ALL W/ 1.125" OR 1.375" PTO SHAFT)

A-E7NN797BA PTO Sleeve 0.16 Lbs.



For Models: (2000, 4000, 600, 700, 800, 900 ALL W/ 1.375" DIA. PTO)

A-C5NNN705A Sleeve, PTO Intermediate Shaft 1.72 Lbs.



For Models: (2000, 3000, 4000 ALL W/6SP / 8SP TRANS.)

A-D1NN745B Gear, PTO Drive 1.8 Lbs.



For Models: (4000, 5000, 6600, 6610 ALL W/SINGLE SP PTO), (5000, 7000 ALL 1965-1975), (5600, 5700, 6600, 6700, 7600, 7700 ALL 1975-1981), (5610, 6610, 6710, 7610, 7710 ALL 1981-10/1991), (5640, 6640, 7740 ALL 11/91>), (5610S, 6610S, 7610S ALL 1/1994>)

A-C5NN717A Sleeve, PTO Clutch 2 Lbs.

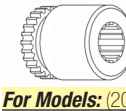

For Models: (2000, 3000 ALL W/6SP, 7SP, / 8SP TRANS.)

A-D9NNN710CA PTO Seal 0.09 Lbs.



For Models: (5000, 5600, 5610, 6600, 6610, 6700, 6710, 7000, 7600, 7610, 7700, 7710 ALL W/ SINGLE SPEED TRANSMISSION)

*** Truck icon indicates the item is shipped via truck freight. ***

PTO Parts

A-C5NNA726A Gear, PTO Driven 16.3 Lbs.

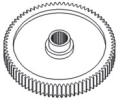

For Models: 5000 W/SINGLE SP PTO

A-E0NN745AA Gear, PTO Drive 5.93 Lbs.



For Models: (5640, 6640, 7740, 7840, 8240, 8340 ALL NON-SHIFTABLE 11/1991>), (7810, 7910, 8210 ALL NON-SHIFTABLE 1982-10/1991), (5610S, 6610S, 7610S, 7810S ALL 1/1994>), (5610, 6610, 6710, 7610, 7710 ALL 1981-10/1991), 7010S 4/1996>

A-E0NNA726AD Gear, PTO Driven (540 RPM) 15.7 Lbs.

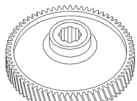

For Models: (5640, 6640, 7740, 7840, 8240, 8340 ALL NON-SHIFTABLE 11/1991>), (7810, 7910, 8210 ALL NON-SHIFTABLE 1982-10/1991), (5610S, 6610S, 7610S, 7810S ALL 1/1994>), (5610, 6610, 6710, 7610, 7710 ALL 1981-10/1991), 7010S 4/1996>

A-E0NNA726BA Gear, PTO Driven (1000 RPM) 13.3 Lbs.

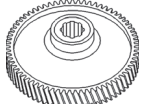

For Models: (5640, 6640, 7740, 7840, 8240, 8340 ALL NON-SHIFTABLE 11/1991>), (7810, 7910, 8210 ALL NON-SHIFTABLE 1982-10/1991), (5610S, 6610S, 7610S, 7810S ALL 1/1994>), (5610, 6610, 6710, 7610, 7710 ALL 1981-10/1991), 7010S 4/1996>

A-9N715C PTO Shaft Bearing (Outer) 0.45 Lbs.

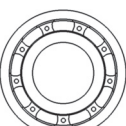

For Models: NAA <1955 W/ 1 3/8" OR 1 1/8" PTO SHAFT, (2N, 8N, 9N ALL W/ 1 3/8" OR 1 1/8" PTO SHAFT)

A-C5NNN872A Shroud, Hydraulic Pump Drive Gear 0.3 Lbs.



For Models: (3000, 340, 3900, 4000, 4100, 4140, 4190, 420, 4200, 4330, 4340, 4400, 4410, 445, 4500, 4600, 4600NO, 4600SU, 515, 532, 540, 545 ALL W/ Independent PTO)

A-310089 Housing, PTO Shaft 3.24 Lbs.

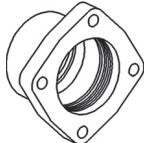

For Models: (2000, 4000, 600, 700, 800, 900 ALL ORIGINALLY EQUIPPED W/ 1 3/8" PTO SHAFT)

A-81879096 Hub, PTO Drive Clutch 2.88 Lbs.



For Models: (5000, 5110, 5610, 5900, 6410 (UK), 6600, 6610, 6710, 6810, 7410, 7610, 7710, 7810, 7910, 8210 ALL W/2SP / SINGLE SP PTO)

A-E1NNN777AB Hub, Standard 4.48 Lbs.

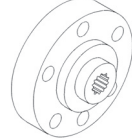

For Models: TW10, TW20, TW5, 5000, 5100, 5110, 5600, 5610, 5700, 5900, 6600, 6610, 6700, 6710, 6810, 7100, 7200, 7410, 7600, 7610, 7700, 7710, 7910, 8000, 8200, 8400, 8600, 8700, 9000, 9200, 9600, 7000 DUAL RANGE 7/8 SPEED TRANS 65-75, (8210, 9700 ALL W/ DUAL RANGE TRANS)

A-D8NNN778AA Hub, Heavy PTO Drive 4.06 Lbs.

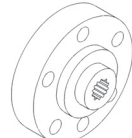

For Models: (8530, 8830 ALL 3/90->), (TW10, TW20, TW30 ALL 79-83), (TW15, TW25, TW35, TW5 ALL 83->)

A-F1NNN777AA Hub, PTO Drive 4.44 Lbs.



For Models: TS100, TS110, TS90, 5640, 6640, 7740, 7840, 8240, 8340

A-D5NNN707A Housing, PTO Drive Clutch 8 Lbs.

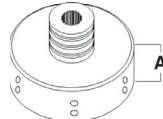

For Models: 5000, 5100, 5200, 5340, 5600, 5700, 6600, 6700, 7000, 7100, 7200, 7600, 7700

A-E0NNN707AA Housing, PTO Clutch 8 Lbs.

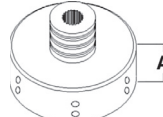

For Models: 5110, 5610, 6410 (UK), 6610, 6710, 6810, 7010, 7410, 7610, 7710, 7810, 7910, 8010, 8210, TB100, TB110, TS100, TS110, TS90

A-C5NN7A684A PTO Shaft 11.8 Lbs.

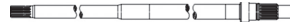

For Models: 5000, 5110, 5600, 5610, 5700, 5900, 6410, 6600, 6610, 6700, 6710, 6810, 7000, 7600, 7610, 7700, 7710

A-83948847 PTO Shaft 12.34 Lbs.



For Models: (5000, 5100, 5110, 5600, 5610, 5700, 5900, 6410, 6600, 6610, 6700, 6710, 6810, 7000, 7100, 7200, 7600, 7610, 7700, 7710 ALL LESS SYNC TRANS)

A-C5NNA701A PTO Shaft 9.04 Lbs.



For Models: (5000, 6600, 6610 ALL W/SINGLE SP PTO)

A-E1NN7A684AB PTO Shaft 11.2 Lbs.



For Models: (5100, 5110, 5600, 5610, 5900, 6410, 6600, 6610, 6700, 6710, 6810, 7100, 7200, 7600, 7610, 7700, 7710 ALL W/ SYNC TRANS)

A-4950663 Shaft, PTO Drive 6.1 Lbs.



For Models: (3010S, 4010S, 5010S ALL SN 400001M>), TT55, TT60A, TT65, TT75, TT75A

A-5189501 Shaft, PTO Drive 7.8 Lbs.

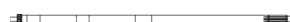

For Models: 4230, 4430, 5030, 6530, TD60D, TD70D, TD75D, TD80D, TD90D

A-C9NN7A684A Shaft, PTO Drive 11.42 Lbs.



For Models: 8000, 8200, 8400, 8600, 8700, 9000, (9200, 9600, 9700 ALL 9/69-78)

AGCO
ALLIS
CHALMERS
DEUTZ
MASSEY
FERGUSON
WHITE/
OLIVER

CNH

CASE-IH

FORD / NEW
HOLLAND

FIAT

BELARUS

BOBCAT

JCB

JOHN
DEERE

KUBOTA

LANDINI

LEYLAND

LONG

McCORMICK

OTHER

RENAULT

SAME

VALTRA

VERSATILE

YANMAR

ZETOR

SCHWARTZ
SPEECO

*** Truck icon indicates the item is shipped via truck freight. ***

PTO Parts

A-C7NN7A684D Shaft, PTO Drive 11.9 Lbs.

For Models: (8000, 8700, 9000, 9700 ALL 68-8/69)

AGCO **A-FONN7A684AB** PTO Shaft 12 Lbs.

ALLIS
CHALMERS *For Models:* (5640, 6640, 7740, 7840, 8240, 8340 ALL LESS DUAL POWER)

DEUTZ **A-D8NN7A684AB** Shaft, PTO Drive 11.64 Lbs.

MASSEY *For Models:* (TW10, TW20, TW30 ALL 79->)

FERGUSON **A-D8NN7A684BA** Shaft, PTO Drive 12 Lbs.

WHITE/OLIVER *For Models:* (8000, 8600, 8700, 9000, 9700 ALL 9/69-78 HVY DUTY)

A-C5NN772A PTO Input Shaft 4.4 Lbs.

For Models: (2000, 2100, 2300, 2310, 3000, 3055, 3100, 3110, 3120, 3150, 3190, 3300, 3310, 3330, 3400, 3500, 4000, 4100, 4110, 4140, 4190, 4200, 4330, 4340, 4400, 4500 ALL 1965> W/ Live PTO), (231, 233, 2600, 333, 3600, 531 ALL 1975> W/ Live PTO), (234, 2610, 334, 3610, 530A ALL 1981 - 4/1983 W/ Live PTO)

CNH

CASE-IH **A-NAA70038** PTO Assembly 19 Lbs.

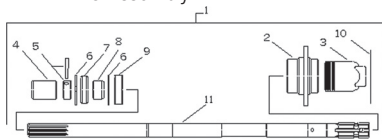

A-9N733B Housing, PTO Assembly (Ref. 2) 3.04 Lbs.

A-310088 Cover, PTO Shaft (Ref. 3) 1.88 Lbs.

A-NAA722C Seal, Retaining Collar (Ref. 4) 0.61 Lbs.

A-NAA70038C Collar w/ Tapered Pin (Ref. 5) 0.18 Lbs.

A-9N754 Snap Ring (2 Used, Ref. 6) 0.02 Lbs.

A-9N715BC Bearing, Front PTO Shaft (Ref. 7) 0.45 Lbs.

A-9N73538 Seal Sleeve, PTO Shaft (Ref. 8) 0.27 Lbs.

A-D8NN703AA Seal, PTO Shaft (Ref. 9) 0.1 Lbs.

A-C5NN747A Gasket, PTO Housing (Ref. 10) 0.01 Lbs.

A-NAA70038S Shaft, PTO (Ref. 11) 9.5 Lbs.

For Models: NAA 1953-54

KUBOTA **A-9N70038** PTO Assembly 14.9 Lbs.

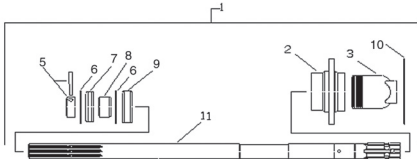

A-9N733B Housing, PTO Assembly (Ref. 2) 3.04 Lbs.

A-310088 Cover, PTO Shaft (Ref. 3) 1.88 Lbs.

A-NAA70038C Collar w/ Tapered Pin (Ref. 4) 0.18 Lbs.

A-9N754 Snap Ring (2 Used) (Ref. 5) 0.02 Lbs.

A-9N715BC Bearing, Front PTO Shaft (Ref. 6) 0.45 Lbs.

A-9N73538 Seal Sleeve, PTO Shaft (Ref. 7) 0.27 Lbs.

A-D8NN703AA Seal, PTO Shaft (Ref. 8) 0.1 Lbs.

A-C5NN747A Gasket, PTO Housing (Ref. 9) 0.01 Lbs.

For Models: 2N, 8N, 9N

VERSATILE

YANMAR

ZETOR

SCHWARTZ
SPEECO

A-NCA70038 PTO Shaft Assembly 20 Lbs.

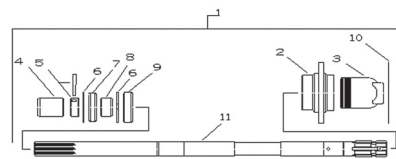

A-9N733B Housing, PTO Assembly (Ref. 2) 3.04 Lbs.

A-310088 Cover, PTO Shaft (Ref. 3) 1.88 Lbs.

A-NAA722C Seal, Retaining Collar (Ref. 4) 0.61 Lbs.

A-NAA70038C Collar w/ Tapered Pin (Ref. 5) 0.18 Lbs.

A-9N754 Snap Ring (2 Used, Ref. 6) 0.02 Lbs.

A-9N715BC Bearing, Front PTO Shaft (Ref. 7) 0.45 Lbs.

A-9N73538 Seal Sleeve, PTO Shaft (Ref. 8) 0.27 Lbs.

A-D8NN703AA Seal, PTO Shaft (Ref. 9) 0.1 Lbs.

A-C5NN747A Gasket, PTO Housing (Ref. 10) 0.01 Lbs.

A-NCA70038S PTO Shaft (Ref. 11) 10.34 Lbs.

For Models: 600, 800, 900

A-312428 PTO Shaft, HD 1 3/8" 12.3 Lbs.

For Models: 2000, 4000, 600, 700, 800, 900

A-C7NN702B PTO Countershaft 8.48 Lbs.

For Models: (2000, 3000, 4000 ALL W/LIVE PTO / 6SP / 8SP TRANS.)

A-C7NN702A PTO Countershaft 8.16 Lbs.

For Models: (3550, 4400, 4500 ALL W/INDEPENDENT PTO / MAN. REVERSE TRANS. 4/68 / UP)

A-E3NN725BB Shaft, PTO (540 RPM) 14.75 Lbs.

For Models: (250C, 260C, 2810, 2910, 3230, 335, 340A, 340B, 3430, 345C, 345D, 3910, 3930, 4110, 4130, 445A, 445C, 445D, 455C, 455D, 4610, 4630, 4830, 5030, 540A, 540B, 545A, 545C, 545D ALL W/INDEPENDENT PTO & 4WD)

A-C5NNA701K PTO Shaft 9.5 Lbs.

For Models: (2000, 3000 ALL W/ 4SP TRANS / 65-70)

A-E5NNA728AA PTO Rear Shaft (10 Spline) 10.8 Lbs.

For Models: (2000, 3000, 3600, 3610 ALL W/6SP, 7SP, 8SP, / MAN. REVERSE TRANS.)

A-D8NN725AB PTO Shaft 15.18 Lbs.

For Models: 2600, 2610, (2810, 2910 ALL W/ IND PTO), 3100, 3600, 3610, 3900 W/ 7, 8, / MANUAL REVERSE 10/80->, 3910 W/ IND PTO, (3930, 3930H, 3930N, 3930NO ALL W/ IND PTO & 2 WD), 4100 W/ 7, 8, / MANUAL REVERSE 10/80->, 4110 W/ IND PTO, (4130, 4130N, 4130NO ALL W/ IND PTO & 2 WD), 4600 W/ 7, 8, / MANUAL REVERSE 10/80->, 4610 W/ IND PTO

A-C5NNA701C Shaft, PTO (540 RPM) 10.68 Lbs.

For Models: (2000, 3000, 4110 ALL W/ SELECTO SPEED TRANS / SINGLE SPEED PTO)

A-D3NN710D PTO Shaft 12.94 Lbs.

For Models: 3000, 3550, 4000, 4100, 4110, 4140, 4200, 4330, 4340, 4400, 4410, 4500, (3900, 4600, 515, 532 ALL 1/75-9/80), (340, 340A, 340B, 445, 445A, 540, 540A, 540B, 545, 545A ALL 1/78-9/80)

A-9840406 Shaft, Out-Put 12.3 Lbs.

For Models: 8770, 8770A, 8870, 8870A, 8970, 8970A

*** Truck icon indicates the item is shipped via truck freight. ***

PTO Parts

A-9843942 Shaft, Out-Put 11.2 Lbs.

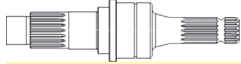

For Models: 8770, 8770A, 8870, 8870A, 8970, 8970A

A-D8NNB733AC PTO Output Shaft Sleeve 2.54 Lbs.



For Models: (5640, 6640, 7740, 7840, 8240, 8340 ALL NON-SHIFTABLE 11/1991->), (7810, 7910, 8210 ALL NON-SHIFTABLE 1982-10/1991), (5610S, 6610S, 7610S, 7810S ALL 1/1994->), (TW10, TW20 ALL 1979-1982), (5610, 6610, 6710, 7610, 7710 ALL 1981-10/1991), (TW15, TW25, TW5 ALL 1983-2/1990), 7010S 4/1996->

A-83924761 Shaft, Upper PTO 6.7 Lbs.



For Models: 5110, 5610, 5610S, 5640, 5900, 6410, 6610, 66100, 6610S, 6640, 66400, 6710, 6810, 6810S, 7010 SN 850001M>, 7410, 7610, 76100, 7610S, 7710, 7740, 77400, 7810, 78100, 7810S, 7840, 78400, 7910, 8010 SN 800001M>, 8210, 8240, 8340, TB100, TB110, TB120, TB80, TB85, TB90, TS100, TS110, TS115, TS90, TV140, TV145

A-5171332* Shaft, PTO (540 RPM) 3.6 Lbs.

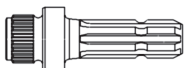

For Models: (5110, 5610, 5640, 6410, 6610, 6640, 6710, 6810, 7410, 7710, 7740, 7810, 7840, 7910, 8210, 8240, 8340 ALL W/ 2 SPEED SHIFTABLE PTO), (TL100, TL70, TL80, TL90 ALL W/ 2 SPEED SHIFTABLE PTO SN <1302901), (TS100, TS110 ALL W/ 2 SPEED SHIFTABLE PTO W/O ELECTRONIC DRAFT CONTROL), TS115 W/ 2 SPEED SHIFTABLE PTO, ELECTRIC, TS90 W/ 2 SPEED SHIFTABLE PTO W/O ELECTRONIC DRAFT CONTROL

A-D2NNB728A Shaft, PTO (540 RPM) 7 Lbs.

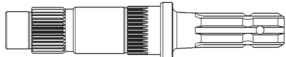

For Models: (5100, 5200, 7100, 7200 ALL W/ 2SP 6/73->), (8000, 9000 ALL W/ 2SP 68-78), (5600, 5700, 6600, 6700, 7600, 7700 ALL W/ 2SP 75->)

A-D2NNB728B Shaft, PTO (1000 RPM) 7.08 Lbs.



For Models: (5100, 5200, 7100, 7200 ALL W/ 2SP 6/73->), (8000, 9000 ALL W/ 2SP 68-78), (5600, 5700, 6600, 6700, 7600, 7700 ALL W/ 2SP 75->)

A-D2NNN752C Shaft, PTO (540 RPM) 5.4 Lbs.

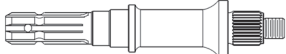

For Models: 5100, 5200, 7100, 7200, (5000, 7000 ALL IND PTO, 65-5/73)

A-E4NNN752AA Shaft, PTO (540 RPM) 6.6 Lbs.



For Models: (5000, 7000 ALL IND 6/73->), (5600, 5700, 6600, 6700, 7600, 7700 ALL W/ SINGLE SP), (5110, 5610, 5900, 6410, 6610, 6710, 6810, 7610, 7710 ALL W/ SINGLE SP 81-9/89)

A-E8NN710AA Shaft, PTO (540 RPM) 8.92 Lbs.

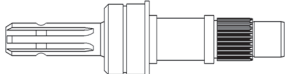

For Models: (5110, 5610, 5900, 6410, 6410 (UK), 6610, 6710, 6810, 7610, 7710 ALL W/ SINGLE SPEED PTO 10/89->), (5640, 6640, 7740 ALL W/ SINGLE SPEED 11/90->)

A-E6NNB728AA Shaft, PTO (540 RPM) 6.74 Lbs.



For Models: (TW10, TW20 ALL 79->), (5110, 5610, 5900, 6410, 6610, 6710, 6810, 7610, 7710 ALL W/ 2SP NON-SHIFT PTO 81->), 7810 2 SP 82->, (7910, 8210 ALL 2SP 82->), (TW15, TW25, TW5 ALL 83->), (5640, 6640, 7740, 7840, 8240, 8340 ALL W/ 2SP NON-SHIFT PTO 11/91->), (5100, 5600, 6600, 6700, 7100, 7600, 7700, 8000, 8670, 8700, 9700 ALL 2SP 9/93->), TB100, TB110, TB120, TS100, TS110, TS90, TV140, TV145

A-D8NNB728BC Shaft, PTO (1000 RPM) 6.88 Lbs.

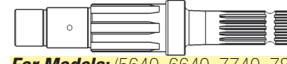

For Models: (5640, 6640, 7740, 7840, 8240, 8340 ALL W/ 2SP NON-SHIFT PTO 11/91->), (5110, 5610, 5900, 6410, 6610, 6710, 6810, 7610, 7710 ALL W/ 2SP NON-SHIFT PTO 81->), (7910, 8210 ALL 2SP 82->), (5100, 5600, 6600, 6700, 7100, 7600, 7700, 8000, 8670, 8700, 9700 ALL 2SP 9/93->), (TW10, TW20 ALL 79->), (TW15, TW25, TW5 ALL 83->)

A-E7NNB728BA Shaft, PTO (1000 RPM) 3.3 Lbs.

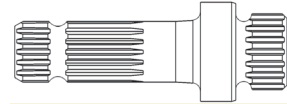

For Models: (5640, 6640, 7740, 7840 ALL 2SP SHIFTABLE 10/89->), 8340 2SP SHIFTABLE 11/91->

A-D8NNB728CC Shaft, PTO (1000 RPM) 8.96 Lbs.



For Models: 8670, TW30 SINGLE SPEED 79->, TW35 SINGLE SPEED 83->

A-83953236 PTO Circlip 0.05 Lbs.



Dim/Info:
sold in multiples of 5

For Models: 4635, 4835, 5000 < 06/01/73, 5110, 5600 < 01/01/75, 5610, 5635, 5640, 5700, 6410, 6600, 6610, 6635, 6640, 6700, 6710, 6810, 7000 < 06/01/73, 7410, 7600, 7610, 7635, 7700, 7710, 7740, 7810, 7840, 7910, 8210, 8240, 8340, 8530, 8630, 8670, 8670A, 8730, 8770, 8770A, 8830, 8870, 8870A, 8970, 8970A, TM115, TM125, TM135, TM150, TM165, TS100, TS110, TS115, TS80, TS90, TV140, TW10, TW15, TW20, TW25, TW30, TW5

A-D8NNC737BB Brake Pad, PTO 0.4 Lbs.

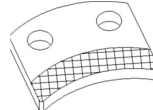

For Models: TW5, TW10, TW15, TW20, TW25, TW30, TW35, 8530, 8630, 8730, 8830

A-D8NNC736BB Brake Pad, PTO 0.45 Lbs.

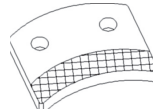

For Models: TW5, TW10, TW15, TW20, TW25, TW30, TW35, 8530, 8630, 8730, 8830

A-PBB77517A Snap Ring, Drive Clutch Piston Spring Retainer 0.02 Lbs.



For Models: 2000, 2130, 2310, 3000, 3110, 3120, 3310, 3330, 4000, 4030, 4040, 4110, 4120, 4130, 4140, 4330, 4340, 4410, 5000, 5600, 5700, 5900, 6000, 601, 611, 620, 6410, 6600, 6610, 6640, 6710, 6810, 7000, 701, 7010, 7100, 7200, 741, 7410, 7600, 7610, 7700, 7710, 7740, 7810, 7840, 7910, 8000, 801, 8010, 811, 8210, 8240, 8340, 8400, 841, 850, 851, 8530, 8600, 8630, 8700, 8730, 9000, 9600, TB100, TB110, TS100, TS110, TS115, TS90, TV140, TV145, TW10, TW15, TW20, TW25, TW30, TW35, TW5

AGCO
ALLIS
CHALMERS
DEUTZ
MASSEY
FERGUSON
WHITE/
OLIVER

CNH

CASE-IH

FORD / NEW
HOLLAND

FIAT

BELARUS

BOBCAT

JCB

JOHN
DEERE

KUBOTA

LANDINI

LEYLAND

LONG

McCORMICK

OTHER

RENAULT

SAME

VALTRA

VERSATILE

YANMAR

ZETOR

SCHWARTZ
SPEECO

*** Truck icon indicates the item is shipped via truck freight.***