

# Engine Parts

**A-71125804** Bowl, Pre-Cleaner (7") 0.40 Lbs.

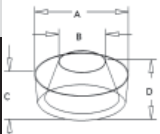

**Dim/Info:**  
 A - 7.250"  
 B - 3.500"  
 C - 3.000"  
 D - 4.125"

**For Models:** FITS SEVERAL MODELS

**A-1508881M1** Bowl, Pre-Cleaner (7") 0.40 Lbs.

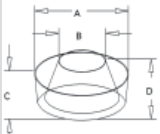

**Dim/Info:**  
 A - 7.250"  
 B - 3.500"  
 C - 3.000"  
 D - 4.125"

**For Models:** 6240, (6240, 6250, 6260 ALL VC), 6260 SC, 7085

**A-70651270** Bowl, Pre-Cleaner (10") 0.60 Lbs.

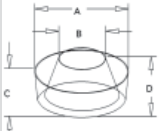

**Dim/Info:**  
 A - 10.500"  
 B - 5.562"  
 C - 3.000"  
 D - 4.000"

**For Models:** FITS SEVERAL MODELS

**A-1693129M1** Pre-Cleaner 1.54 Lbs.

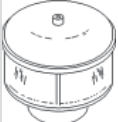

**Dim/Info:**  
 6.89" Bowl Dia.  
 2.953" Inlet Dia.  
 4.921" Body Height

**For Models:** (6240, 6250 ALL VC), 6260 SC, 7085

**A-3380636M1** Pre-Cleaner 3.58 Lbs.  
*Replaces:* 2708734M91



**Dim/Info:**  
 10.433" Bowl Dia.  
 3.937" Inlet Dia.  
 5.709" Body Height

**For Models:** 7085, 7120, 7145

**A-04318399** Pre-Cleaner Assembly 3.74 Lbs.



**Dim/Info:**  
 10.433" Bowl Dia.  
 3.15" Inlet Dia.  
 5.512" Body Height

**For Models:** 7085, 7120, 7145

**A-04318403\*** Pre-Cleaner Assembly 3.58 Lbs.



**Dim/Info:**  
 10.433" Bowl Dia.  
 3.937" Inlet Dia.  
 5.709" Body Height

**For Models:** 7085, 7120, 7145

**A-94400** Centri Rubber Hump Hose w/2 Clamps 4"-5 1/2" Long 1.60 Lbs.



**For Models:** ALL MODELS

**A-94500** Centri Rubber Hump Hose w/2 Clamps 5"-6" Long 1.90 Lbs.



**For Models:** ALL MODELS

**A-954030** Centri Rubber Hump Hose Reducer w/2 Clamps 4"-3" 5.25" Long 1.50 Lbs.



**For Models:** ALL MODELS

**A-954045** Centri Rubber Hump Hose Reducer w/2 Clamps 4"-4.5" 1.80 Lbs.



**For Models:** ALL MODELS

**A-955040** Centri Rubber Hump Hose Reducer w/2 Clamps 5"-4" 5.5" Long 1.90 Lbs.



**For Models:** ALL MODELS

**A-972522** Centri Rubber Hump Hose Reducer w/2 Clamps 2 1/2"-2 1/4" 0.10 Lbs.



**For Models:** ALL MODELS

**A-973027** Centri Rubber Hump Hose Reducer w/2 Clamps 3"-2 3/4" 0.10 Lbs.

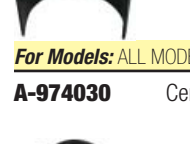

**For Models:** ALL MODELS

**A-974030** Centri Rubber Hump Hose Reducer w/2 Clamps 4"-3" 0.40 Lbs.

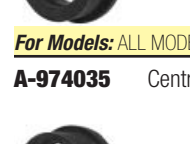

**For Models:** ALL MODELS

**A-974035** Centri Rubber Hump Hose Reducer w/2 Clamps 4"-3 1/2" 0.30 Lbs.

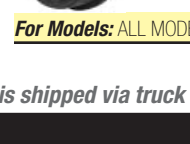

**For Models:** ALL MODELS

\*\*\* Truck icon indicates the item is shipped via truck freight. \*\*\*

# Engine Parts

**A-974037** Centri Rubber Hump Hose Reducer w/2 Clamps 4"-3 3/4"  
0.20 Lbs.



**For Models:** ALL MODELS

**A-975040** Centri Rubber Hump Hose Reducer w/2 Clamps 5"-4"  
0.70 Lbs.



**For Models:** ALL MODELS

**A-975045** Centri Rubber Hump Hose Reducer w/2 Clamps 5"-4 1/2"  
0.50 Lbs.



**For Models:** ALL MODELS

**A-975047** Centri Rubber Hump Hose Reducer w/2 Clamps 5"-4 3/4"  
0.30 Lbs.



**For Models:** ALL MODELS

**A-976050** Centri Rubber Hump Hose Reducer w/2 Clamps 6"-5"  
0.70 Lbs.



**For Models:** ALL MODELS

**A-EX25** Centri Precleaner Assembly, w/2 1/2" Inlet 2.30 Lbs.



**Dim/Info:**  
6.500"  
4.250"  
2.500"  
100-200

**For Models:** ALL MODELS

**A-EX30** Centri Precleaner Assembly, w/3" Inlet 3.30 Lbs.



**Dim/Info:**  
6.500"  
5.000"  
3.000"  
150-275

**For Models:** ALL MODELS

**A-EX40** Centri Precleaner Assembly, w/4" Inlet 4.70 Lbs.



**Dim/Info:**  
8.875"  
5.875"  
4.000"  
200-400

**For Models:** ALL MODELS

**A-EX50** Centri Precleaner Assembly, w/5" Inlet 7.10 Lbs.



**Dim/Info:**  
11.250"  
7.500"  
5.000"  
350-700

**For Models:** ALL MODELS

**A-EX60** Centri Precleaner Assembly, w/6" Inlet 9.20 Lbs.



**Dim/Info:**  
12.750"  
7.750"  
6.000"  
500-950

**For Models:** ALL MODELS

**A-70209292** Ring Gear, Flywheel 1.62 Lbs.



**Dim/Info:**  
11.43" O.D.  
10.645" I.D.  
.50" Thick  
90 Tooth

**For Models:** B, C, CA

**A-70208132** Ring Gear, Flywheel 2.20 Lbs.

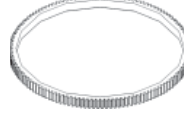

**Dim/Info:**  
12.68" O.D.  
11.725" I.D.  
.50" Thick  
100 Tooth

**For Models:** WC, WD, WD45, WF

**A-70226830** Ring Gear, Flywheel 2.23 Lbs.



**Dim/Info:**  
14.0625" O.D.  
13.125" I.D.  
139 Tooth

**For Models:** W226 SN PU96714> W/ GAS ENGINE, (D17, 170, 175 ALL W/ GAS ENGINE)

**A-70233196** Ring Gear, Flywheel 1.60 Lbs.



**Dim/Info:**  
116 TEETH  
11.785" MAJOR DIA.  
11.400" MINOR DIA.

**For Models:** D10 Tractor SN 3501>, D12 Tractor SN 3001>, D14 TRACTOR SN 19001>, D15 GAS/LP

**A-74001167** Ring Gear, Flywheel 4.00 Lbs.



**For Models:** 4W220, 7030, 7040, 7045, 7050, 7060, 7080, 7580, 8030, 8050, 8070

**A-70236741** Pulley, Crankshaft 2.80 Lbs.



**Dim/Info:**  
1.125" Bore  
5.000" Dia.

**For Models:** D10 SN <3501, D12 SN <3001, D14

**A-74009853** Pulley, Crankshaft 19.45 Lbs.



**For Models:** 200

AGCO  
ALLIS  
CHALMERS

DEUTZ  
MASSEY  
FERGUSON  
WHITE/  
OLIVER

CNH  
CASE-IH

FORD / NEW  
HOLLAND  
FIAT

BELARUS

BOBCAT

JCB

JOHN  
DEERE

KUBOTA

LANDINI

LEYLAND

LONG

McCORMICK

OTHER

RENAULT

SAME

VALTRA

VERSATILE

YANMAR

ZETOR

SCHWARTZ

SPEECO

\*\*\* Truck icon indicates the item is shipped via truck freight. \*\*\*

# Engine Parts

**A-74009848** Pulley, Crankshaft Dampener 20.00 Lbs.  
*Replaces:* 74007157



*For Models:* 7000, 7010, 7020, 8010

**A-74037126** Pulley, Crankshaft (3 Groove) 19.04 Lbs.  
*Replaces:* 74028472



*Dim/Info:*  
 7.562" OD  
 3 Groove

*For Models:* 7030, 7040, 7045, 7050, 7060, 8030, 8050

**A-7022540** Seal, Rear Engine Clutch 0.20 Lbs.



*For Models:* WD, WD45

**A-70227038** Gear, Camshaft Timing 5.14 Lbs.  
*Replaces:* 70203923



*Dim/Info:*  
 54 Tooth

*For Models:* (170, 175, D17, W201 ALL Gas), (W226, WD45 ALL Gas Eng. SN 45-48556->)

**A-70230217** Gear, Crankshaft Timing 1.85 Lbs.



*Dim/Info:*  
 27 Tooth

*For Models:* (D17, 170, 175 ALL Gas), (W226, WD45 ALL Gas Eng. SN 45-11050->)

**A-893501M1** Heater Plug, Thermostat Burner w/ Thread Conn 0.15 Lbs.  
*Replaces:* 13H2468, 2666103

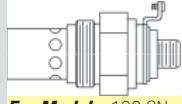

*For Models:* 160 SN <0143067, 170, 175

**A-70225323** Manifold 10.00 Lbs.

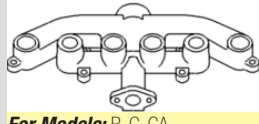

*For Models:* B, C, CA

**A-70226096** Manifold, Gasket 0.10 Lbs.  
 Used w/ 70225323 Manifold



*For Models:* (B, C, CA ALL W/ 125 GAS ENGINE)

**A-70234143** Manifold, Intake & Exhaust 22.92 Lbs.

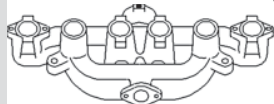

*For Models:* (D14, D15 ALL W/ GAS ENGINE SN<9001)

**A-70257485** Manifold 26.00 Lbs.  
 Gaskets Are NOT Included

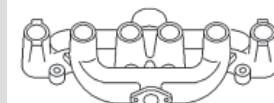

*For Models:* D17 SERIES IV SN 75001> W/ GAS ENGINE, 170 W/ GAS ENGINE

**A-70229416** Manifold, Intake & Exhaust 22.00 Lbs.  
 Manifold Has Improved Larger Throat To Replace 70224782  
*Replaces:* 70224782

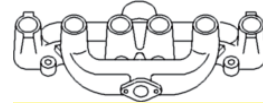

*For Models:* D17 SERIES III W/ GAS ENGINE, (WC, WD, WD45 ALL W/ GAS ENGINE)

**A-70229958** Manifold, Gasket 0.10 Lbs.



*For Models:* 170, 175, D17, WC, WD, WD45, WF

**A-74036827** Manifold, Exhaust (Front) 17.50 Lbs.



*For Models:* 7030, 7040, 7080, 8030, 8050, 8070, 7045 SN 70-20417>, (7050, 7060, 7580 ALL SN 70-20714>)

**A-74007652** Manifold, Exhaust 18.60 Lbs.

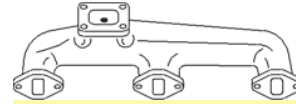

*For Models:* (190, 190XT, 200, 7000, 7010, 7020, 8010 ALL W/ DIESEL ENGINE)

**A-74036828** Manifold, Center 9.10 Lbs.  
*Replaces:* 74036503



*For Models:* 4W220, 7030, 7040, 7045, 7050, 7060, 7080, 7580, 8030

**A-70244418** Elbow, Turbocharger 7.00 Lbs.



*For Models:* 190, 200

**A-70253661** Elbow, Exhaust 6.00 Lbs.



*For Models:* D19, D21, 210, 220, 7000, 7010, 7020

**A-72091261** Elbow, Exhaust 5.00 Lbs.  
*Replaces:* 72089361, 72091541

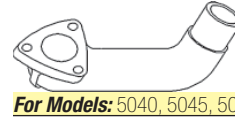

*For Models:* 5040, 5045, 5050 ENG. S/N 600000-699999

**A-70267640** Elbow, Exhaust 9.02 Lbs.

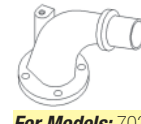

*For Models:* 7030, 7040, 7045, 7050, 7060

\*\*\* Truck icon indicates the item is shipped via truck freight. \*\*\*

# Engine Parts

**A-74009171** Turbocharger 16.70 Lbs.



**For Models:** (190XT, 200, 7000, 7010, 7020, 8010, 545B, 605B ALL T04B80 turbo model)

**A-74063533** Turbocharger 15.30 Lbs.  
**Replaces:** 74062759, 74009831



**For Models:** (TRACTOR: 6060, 6070, 6080)

**A-74057982** Turbocharger 20.00 Lbs.  
**Replaces:** 74036606, 74035196, 74036395, 74062752



**For Models:** 7080, 7580, 8030, 8050, 8070

**A-D4029309** Turbocharger 17.42 Lbs.  
Model T04B90  
**Replaces:** 74029207, 74036513, 74062751, 84062751



**For Models:** 7030, 7040, 7045, 7050, 7060

**A-ZCK26** Carburetor Kit (Zenith) 0.20 Lbs.  
Kit Contains Float Valve, Adjusting Needle, Gaskets, Seals, Washers & Float Pin.



**For Models:** FITS SEVERAL MODELS W/ Zenith Production #'s 12658 & 13957

**A-ZCK13** Carburetor Kit, Complete (Zenith) 0.03 Lbs.  
Complete Carb. Kit Contains All Parts Necessary For Major Carb. Overhaul.

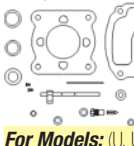

**For Models:** (U, UC ALL W/ Zenith Carb.#: 6496, 6699, 6817)

**A-ZCK10** Carburetor Kit, Complete (Zenith) "Viton" 0.02 Lbs.  
Complete Carb. Kit Contains All Parts Necessary For Major Carb. Overhaul.

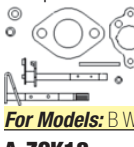

**For Models:** B W/ Zenith Carb.# 9804, OEM Carb. # 70211954

**A-ZCK18** Carburetor Kit, Complete (Zenith) "Viton" 0.02 Lbs.  
Complete Carb. Kit Contains All Parts Necessary For Major Carb. Overhaul.

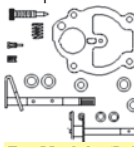

**For Models:** (B, RC ALL W/ Zenith Carb. # 10698A, OEM Carb.#: 70212845)

**A-ZCK02** Carburetor Kit, Complete (Zenith) "Viton" 0.02 Lbs.  
Complete Carb. Kit Contains All Parts Necessary For Major Carb. Overhaul

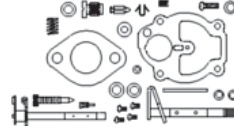

**For Models:** (B, C, RC ALL W/ Zenith Carb.#: 9705, 9706)

**A-ZCK14** Carburetor Kit, Complete (Zenith) 0.02 Lbs.  
Complete Carb. Kit Contains All Parts Necessary For Major Carb. Overhaul

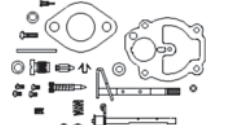

**For Models:** C W/ Zenith Carb.#'s: 10902A, 10903A, OEM Carb.#: 70224640-1

**A-ZCK24** Carburetor Kit, Complete (Zenith) "Viton" 0.02 Lbs.  
Complete Carb. Kit Contains All Parts Necessary For Major Carb. Overhaul.

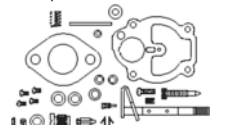

**For Models:** C W/ Zenith Carb. #: 10699A, OEM Carb.#: 70216937

**A-ZCK19** Carburetor Kit, Complete (Zenith) "Viton" 0.02 Lbs.  
Complete Carb Kit Contains All Parts Necessary For Major Carb. Overhaul.

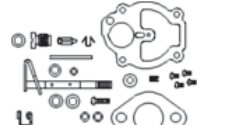

**For Models:** CA W/ Zenith Carb.#: 11141, 11142, OEM Carb.# 70225621-2

**A-ZCK15** Carburetor Kit, Complete (Zenith) "Viton" 0.02 Lbs.  
Complete Carb. Kit Contains All Parts Necessary For Major Carb. Overhaul.

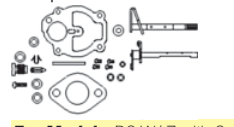

**For Models:** RC W/ Zenith Carb. #: 9507, 9492, OEM Carb.# 70209663, 70209662

**A-ZCK25** Carburetor Kit, Complete (Zenith) "Viton" 0.03 Lbs.  
Complete Carb. Kit Contains All Parts Necessary For Major Carb. Overhaul.

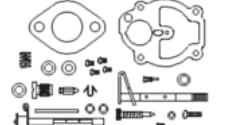

**For Models:** (WC, WF ALL W/ Zenith Carb.# 8979, OEM Carb.# 70209312)

**A-ZCK12** Carburetor Kit, Complete (Zenith) "Viton" 0.03 Lbs.  
Complete Carb. Kit Contains All Parts Necessary For Major Carb. Overhaul

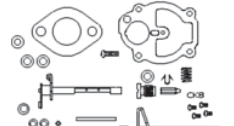

**For Models:** (WC, WD, WF ALL W/ Zenith Carb.#: 9797, A, C, & 10981A, OEM Carb.# 70224749)

**A-MSCK26** Carburetor Kit, Complete (Marvel-Schebler) "Viton" 0.02 Lbs.  
Complete Carb. Kit Contains All Parts Necessary For Major Carb. Overhaul.

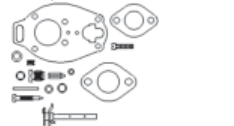

**For Models:** (D17, WD45 ALL W/ Marvel-Schebler Carb.#: TSX464, TSX773)

AGCO  
ALLIS  
CHALMERS

DEUTZ  
MASSEY  
FERGUSON  
WHITE/  
OLIVER

CNH  
CASE-IH  
FORD / NEW  
HOLLAND

FIAT

BELARUS

BOBCAT

JCB

JOHN  
DEERE

KUBOTA

LANDINI

LEYLAND

LONG

MCCORMICK

OTHER

RENAULT

SAME

VALTRA

VERSATILE

YANMAR

ZETOR

SCHWARTZ  
SPEECO

\*\*\* Truck icon indicates the item is shipped via truck freight. \*\*\*

# Engine Parts

**A-ZCK06** Carburetor Kit, Basic (Zenith) 0.02 Lbs.  
Economy Carb. Kit Contains Gaskets & Float Valve Only.

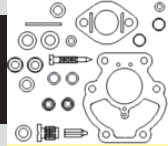

**For Models:** (190, D19 ALL W/ Zenith Carb.#s: 12777, 13303)

**A-ZCK17** Carburetor Kit, Basic (Zenith) "Viton" 0.02 Lbs.  
Basic Carb Kit Includes Gaskets, Float Valve & Throttle Shaft

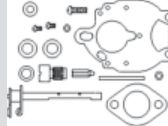

**For Models:** (D17, WD45 ALL W/ Zenith Carb. #: 11588, OEM Carb.# 70227101)

**A-MSCK35** Carburetor Kit, Basic (Marvel-Schebler) 0.02 Lbs.  
Basic Carb. Kits Contain Gaskets, Float Valve & Throttle Shaft. Used With  
OEM Carb.#'s: 70228624, 70234228

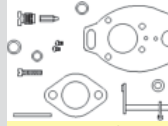

**For Models:** (CA, D14, D15 ALL W/ Marvel-Schebler Carb.#: TSX670, TSX701, TSX815)

**A-MSCK11** Carburetor Kit, Basic (Marvel-Schebler) 0.02 Lbs.  
Economy Carb. Kit Contains Gaskets & Float Valve Only.

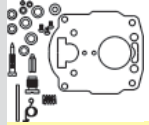

**For Models:** G W/ Marvel-Schebler Carb.#: TSX13

**A-MSCK45** Carburetor Kit, Basic (Marvel-Schebler) 0.50 Lbs.  
Kit Contains: Gaskets Float Valve & Throttle Shaft

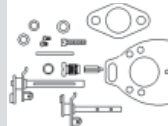

**For Models:** (WC, WD, WF ALL W/ Marvel Schebler Carb.#'s TSX159, TSX422)

**A-MSCK12** Carburetor Kit, Basic (Marvel-Schebler) 0.02 Lbs.  
Economy carb. kit contains gaskets & float valve only.

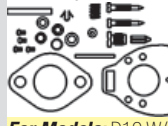

**For Models:** D19 W/ Marvel-Schebler Carb.#: TSX848

**A-MSCK13** Carburetor Kit, Basic (Marvel-Schebler) 0.02 Lbs.  
Economy carb. kit contains gaskets & float valve only.



**For Models:** D17 W/ Marvel-Schebler Carb.#'s: TSX773, TSX869, TSX871

**A-72093848** Pump, Fuel Lift Transfer 2.00 Lbs.



**For Models:** 5040, 5045, 5050

**A-74007968-R** Injector 1.38 Lbs.  
**Replaces:** 74007968



**For Models:** 7000, 7010, 7020

**A-1883344M92** Repair Kit, Fuel Pump 0.29 Lbs.



**For Models:**

**A-70223247** Bail & Nut, Sediment Bowl 0.10 Lbs.  
Used w/ Small Bowl



**For Models:** 170, 175, 180, 185, B, C, CA, D10, D12, D14, D15, D17 Series III, D19, W226, WC, WD, WD45, WF

**A-70237947** Bowl, Fuel Sediment 0.30 Lbs.



**Dim/Info:**  
2.125" O.D.

**For Models:** 170 GAS <170-07500, D15 9001>, D17 42001, D19 12000>, D21 W/D2900 OR D3500 ENG. WC W/LARGE BAIL TYPE BOWL

**A-17C52** Bowl & Gasket, Fuel Sediment 0.14 Lbs.  
Small Bowl



**A-17C51** Bowl, Fuel 0.10 Lbs.

**For Models:** (B, C, CA ALL W/ SMALL BAIL TYPE BOWL), WD, WD45 GAS, D10, D12, D14, D15 <9001, D17 <42001, D19 <12000, 170 GAS <170-07500, 180 DIESEL, 180 GAS, 185, 190, 210, 220

**A-70239167** Strainer, Fuel 0.24 Lbs.  
This Strainer Has 2 Inlets

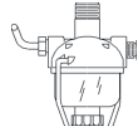

**For Models:** WC, WD, WD45, 170

**A-70237944** Strainer, Fuel 0.24 Lbs.  
w/ Small Bowl

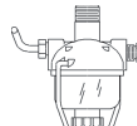

**Dim/Info:**  
3/8" Pipe Thread

**For Models:** B, C, D14, D17, D19

**A-13194D** Screen, Sediment Bowl 0.01 Lbs.  
Used w/ Tall Bowl

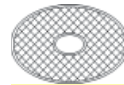

**Dim/Info:**  
7/16" Center Hole

**For Models:** 170 W/ GAS ENGINE SN <170-07500, D15 SN 9001>, D17 SN 42001>, D19 SN 12000>, D21 W/ D2900 OR D3500 ENGINE, WC W/ LARGE BAIL TYPE BOWL

\*\*\* Truck icon indicates the item is shipped via truck freight. \*\*\*

# Engine Parts

**A-70235555** Screen, Fuel Filter 0.01 Lbs.  
Used w/ 70237945 Bowl



**For Models:** D10, D12, D14, D15 SN <9001, D17 SN <42001, D19 SN <12000, WD, WD45 W/ GAS ENGINE, 170 W/ GAS ENGINE SN 170-07500>, 180 GAS & DIESEL, 185, 190, 210, 220, (B, C, CA ALL W/ SMALL BAIL TYPE BOWL)

**A-70208137** Gasket, Sediment Bowl (10 pack) 0.01 Lbs.  
Used w/ 70237947 Bowl; Pkg Qty 10



**Dim/Info:**  
2.125" O.D.

**For Models:** D15 SN 9001>, D17 SN 42001>, D19 SN 12000>, D21 W/ D2900 OR D3500 ENG. WC W/ LARGE BAIL TYPE BOWL, 170 W/ GAS ENG. SN <170-07500

**A-70237946** Strainer, Fuel Assembly (Tall Bowl) 0.71 Lbs.



**Dim/Info:**  
2 1/8" Dia. X 2.370" Long  
Glass Bowl

**A-17C40** Sediment Bowl 0.30 Lbs.

**For Models:** (D15, D17, D19, D21, WC, WD45, WF, 170, 180 ALL Late Model W/ Diesel Engine)

**A-70249218** Sending Unit, Fuel 0.88 Lbs.



**For Models:** 170, 175

**A-70261619** Sending Unit, Fuel 0.73 Lbs.



**For Models:** 180 SN: < 12800, 185

**A-70276224** Sending Unit, Fuel 0.30 Lbs.  
**Replaces:** 70239788



**For Models:** D21, 190, 190XT, 190XTIII

**A-5199933** Sending Unit, Fuel 0.72 Lbs.  
**Replaces:** 72091642, 676887A, 31-2905050, 30-3054292



**For Models:** 5040, 5045, 5050

**A-70273987** Sending Unit, Fuel 0.50 Lbs.



**For Models:** 8010, 8030, 8050, 8070

**A-72161075** Sending Unit, Fuel 0.30 Lbs.  
Used In Upper Tank



**For Models:** 9130, 9150, 9170, 9190

**A-72161989** Sending Unit, Fuel 0.80 Lbs.  
Used In Lower Tank



**For Models:** 9130, 9150, 9170 SN: < 1160 & 1163 >, 9190 SN: 1144 - 1183, < 1243 & 1244 >

**A-17C108** Gasket, Sediment Bowl (15 pack) 0.01 Lbs.  
For Use w/ Short Bowl

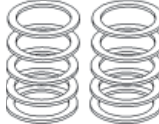

**Dim/Info:**  
2" O.D.  
Sold in Qty of 15, Priced per Piece

**For Models:** 170 GAS SN 170-07500>, 180 GAS & DIESEL, 185, 190, 210, 220, (B, C, CA ALL W/ SMALL BAIL TYPE BOWL), D10, D12, D14, D15 SN <9001, D17 SN <42001, D19 SN <12000, WD, WD45 GAS

**A-41314182** Pump, Oil 4.68 Lbs.  
**Replaces:** 41314054

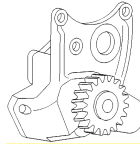

**Dim/Info:**  
For Non Agricultural Use

**For Models:**

**A-4231142** Pump, Engine Oil 7.17 Lbs.  
**Replaces:** 4159966, 4154885, 4230787, 4231306



**For Models:** 7110, 7120, 7145, 9130, 9150, 9630, 9650

**A-4158299** Pump, Oil 4.77 Lbs.



**For Models:** 6240, 6250, 6260, 6265, 6275

**A-2130385** Pump, Engine Oil 5.84 Lbs.

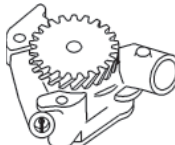

**For Models:** 7085

AGCO  
ALLIS  
CHALMERS

DEUTZ  
MASSEY  
FERGUSON  
WHITE/  
OLIVER

CNH  
CASE-IH  
FORD / NEW  
HOLLAND  
FIAT

BELARUS

BOBCAT

JCB

JOHN  
DEERE

KUBOTA

LANDINI

LEYLAND

LONG

MCCORMICK

OTHER

RENAULT

SAME

VALTRA

VERSATILE

YANMAR

ZETOR

SCHWARTZ

SPEECO

\*\*\* Truck icon indicates the item is shipped via truck freight. \*\*\*

# Engine Parts

**A-303485587** Gauge, Temperature 0.58 Lbs.  
**Replaces:** 180727M91, 1078125M91, 1850512M94, 881396M91, 899455M91, 10A2229, T017273, 15A9741, 10A21284, 100679A



**Dim/Info:**  
 60" Capillary Tube  
 w/ 5/8" UNF Connector  
 2" Body Dia.

**For Models:** WD, WD45

**A-70207834** Gauge, Oil Pressure (80 lb) 0.30 Lbs.



**Dim/Info:**  
 2" Body Dia.

**For Models:** B, C, CA, WC, WD, WD45

**A-9A550** Gauge, Oil Pressure (50 lb) 0.30 Lbs.  
**Replaces:** 70226967, 70228719

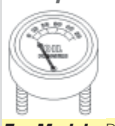

**Dim/Info:**  
 2" Body Dia.

**For Models:** D10, D12, D14, (D15, D17 ALL Gas)

**A-70275840** Gauge, Ammeter (30-0-30) 0.17 Lbs.  
**Replaces:** 208302



**Dim/Info:**  
 2" Dia.

**For Models:** B, C, WC, WD, WD45, WF

**A-70254407** Gauge, Ammeter (60-0-60) 0.17 Lbs.  
**Replaces:** 70240987



**Dim/Info:**  
 2" Dia.

**For Models:** D10, D12, D14, D15, D17, D19, D21, 170, 175, 180 SN <12799, 185, 190, 190XT, 200, 210, 220, G138, G149, G160

**A-1693367M1** Switch, Hydraulic Pressure 0.20 Lbs.

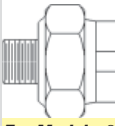

**For Models:** 8745, 8765

**A-3761983M91** Switch, Neutral Safety 0.20 Lbs.  
**Replaces:** 1693818M1, 3697346M91

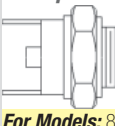

**For Models:** 8745, 8765

**A-70272180** Oil Cooler 7.00 Lbs.

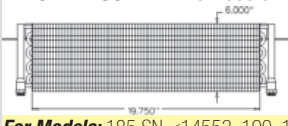

**Dim/Info:**  
 A - 19.750"  
 B - 6.000"

**For Models:** 185 SN <14553, 190, 190XT, 200, 210, 220

**A-3637290M1** Pump, Fuel Lift (4 Hole Mount) 1.30 Lbs.  
**Replaces:** 2641711, 2641725, 3637300M1

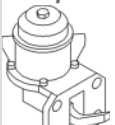

**Dim/Info:**  
 Pump Has 4 Hole Mounting For  
 Models W/ A4-236 & A4-248  
 Diesel Engines.

**For Models:** 170 S/N 236U93188>, 175 S/N 248U8332>

**A-3637307M1** Fuel, Lift Pump (2 Hole Mount) 1.10 Lbs.  
**Replaces:** 886062M91, 2641311, 2641309

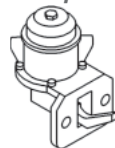

**For Models:** 6040

- AGCO
- ALLIS CHALMERS
- DEUTZ
- MASSEY FERGUSON
- WHITE/OLIVER
- CNH
- CASE-IH
- FORD / NEW HOLLAND
- FIAT
- BELARUS
- BOBCAT
- JCB
- JOHN DEERE
- KUBOTA
- LANDINI
- LEYLAND
- LONG
- McCORMICK
- OTHER
- RENAULT
- SAME
- VALTRA
- VERSATILE
- YANMAR
- ZETOR
- SCHWARTZ SPEECO

\*\*\* Truck icon indicates the item is shipped via truck freight. \*\*\*